

# Coltrónica

PERFIL ESTRUCTURAL EN ALUMINO T SLOT

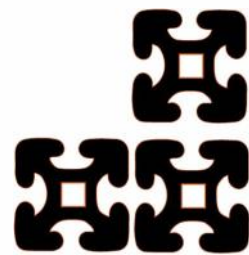



Datos técnicos

Perfil de aluminio extruido según GB5237-2004, superficie anodizada satinada, longitud máxima 5800 mm, datos mecánicos del perfil como se muestra a continuación:

Resistencia a la tensión: min.260N/mm<sup>2</sup>  
 Límite de elasticidad min.240N/mm<sup>2</sup>  
 Elongación: 8%(T≤3.2mm) or 10%(T>3.2~25.0mm)  
 E-Module: approx.70,000N/mm<sup>2</sup>  
 Dureza: HB 75 2.5/187.5  
 espesor capa: min.10μ

Resistencia a la flexión

Para el cálculo de la flexión, consulte las fórmulas siguientes:

f (mm): Flexion  
 F (N): Tipo de carga  
 L (mm): Longitud del perfil  
 I (cm<sup>4</sup>): Momento de inercia  
 E (N/mm<sup>2</sup>): Modulo de elasticidad

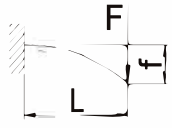
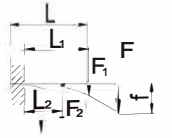
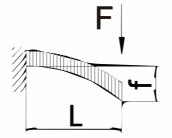
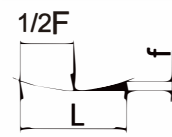
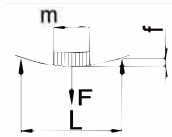
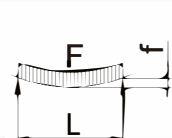
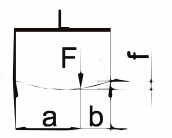
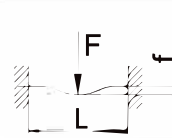
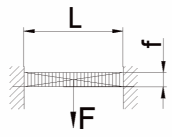
1		$f = \frac{F \cdot L^3}{3E \cdot I \cdot 10^4}$
2		$f = \frac{F \cdot L^3 + F_1 \cdot L_1^2 \cdot L + F_2 \cdot L_2^2 \cdot L}{3E \cdot I \cdot 10^4}$
3		$f = \frac{F \cdot L^3}{8E \cdot I \cdot 10^4}$
4		$f = \frac{F \cdot L^3}{48E \cdot I \cdot 10^4}$
5		$f = \frac{F \cdot L^3}{\left(48 + \frac{29m}{L}\right) \cdot E \cdot I \cdot 10^4}$
6		$f = \frac{5F \cdot L^3}{384E \cdot I \cdot 10^4}$
7		$f = \frac{F \cdot a^2 \cdot b^2}{3E \cdot I \cdot 10^4 \cdot L}$
8		$f = \frac{F \cdot L^3}{192E \cdot I \cdot 10^4}$
9		$f = \frac{F \cdot L^3}{384E \cdot I \cdot 10^4}$

# Perfil estructural Catronica - Datos técnicos

Determinación aproximada de la flexión

Determinación de la deformación:

1. Tipo de carga F en N
2. Longitud del perfil L en mm
3. Desplazamiento del punto de cruce en la diagonal
4. Momento de inercia del perfil seleccionado I en cm<sup>4</sup>
5. Punto de cruce con la diagonal a extenderse verticalmente hasta el fondo
6. Deflexión f para el "Tipo de carga" específico en mm

Ejemplo:

1. F=2,000 N
2. L=1,000 mm
3. Mover el punto de cruce sobre la diagonal
4. I=80,8 cm<sup>4</sup> para el perfil 40x80,06H (1.11.40.040080.06H)
5. Punto de cruce con la diagonal a prolongarse verticalmente hasta el fondo
6. Flexión f para el "Tipo de carga" específico en mm

Tipo de carga 1:  $f=9.5$  mm  
 Tipo de carga 4:  $f=0.6$  mm  
 Tipo de carga 8:  $f=0.15$  mm

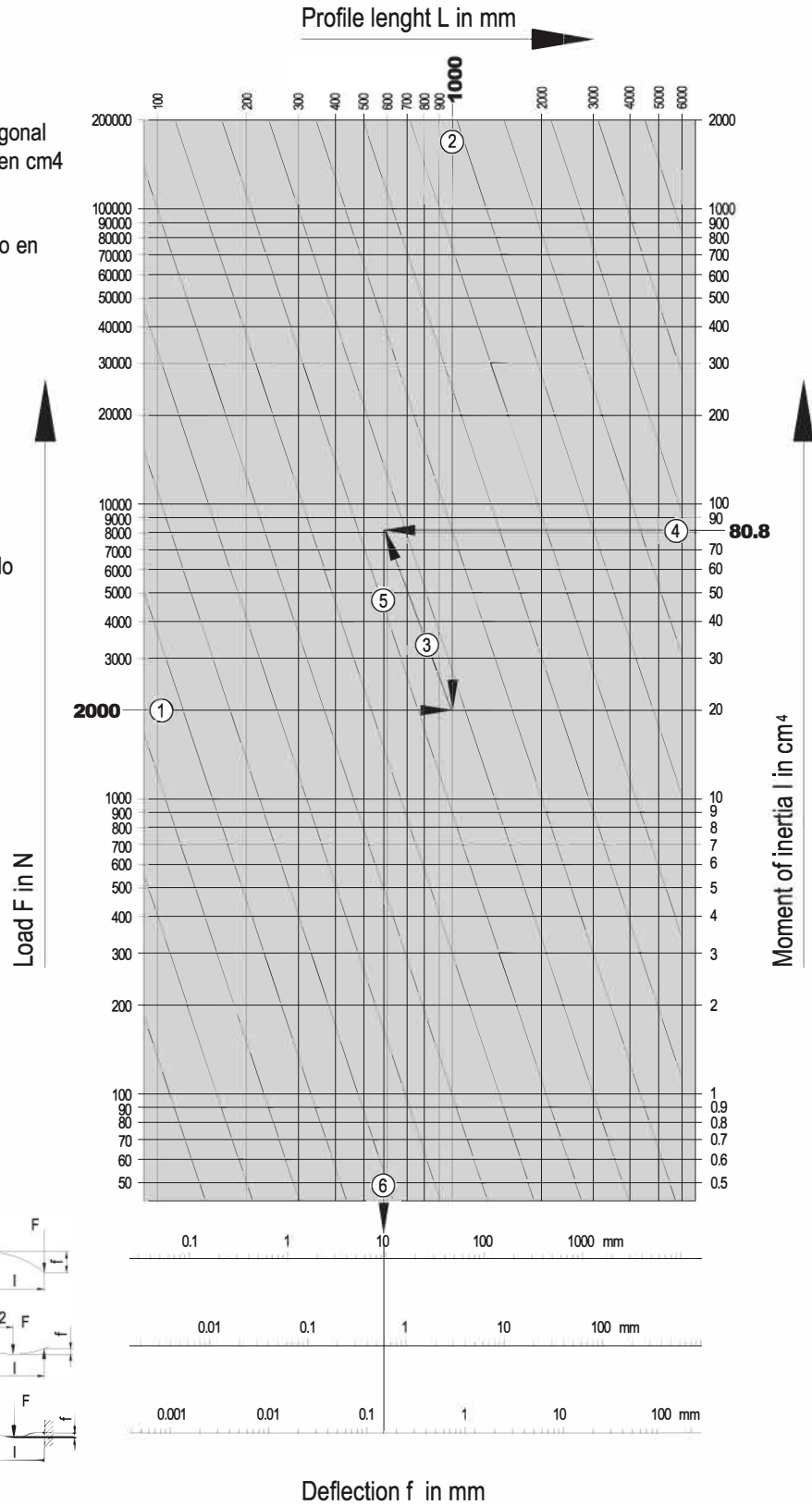

Type of load 1

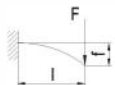

Type of load 4

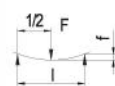

Type of load 8

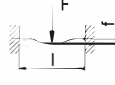

Deflection f in mm



Tolerancia del perfil

Tolerancia al paralelismo

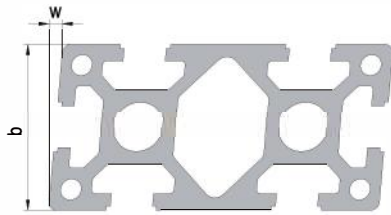

La tolerancia de paralelismo  $w$  (tolerancia angular) se refiere a lados desiguales respecto al lado más corto del ángulo, es decir, se mide a partir del lado más largo.

b (mm)	w (mm)
≤40	0.3
>40~80	0.5
>80~180	1.0

Tolerancia de rectitud

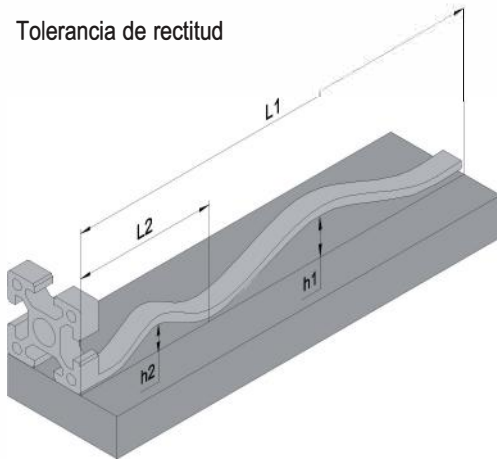

Dado que el perfil se coloca sobre una superficie horizontal de forma estable, la Tolerancia  $h1$  no debe superarse en una determinada longitud  $L1$ ;  $h2$  no debe superarse en la longitud  $L2$  ( $L2=300\text{mm}$   $h2\leq 0.3\text{mm}$ ).

L1(m)	1	2	3	4	5	5.8
h1(mm)	0.7	1.4	2.1	2.8	3.5	4.2

Tolerancia a la torsión

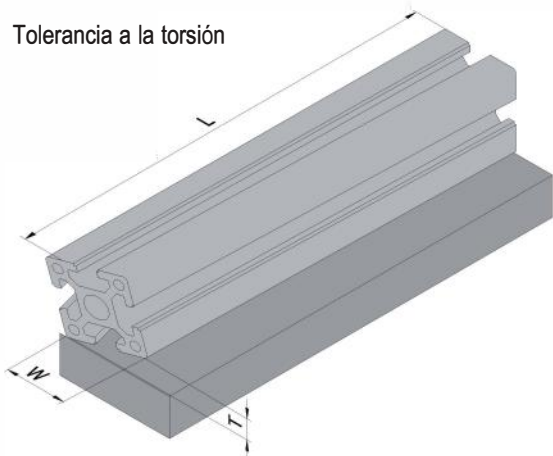

Colocando el perfil sobre una superficie horizontal, si el extremo se inclina debido a la torsión, la altura de torsión ( $T$ ) podría calcularse según la fórmula siguiente:

W (mm)	T (mm)	
	L=1m	L>1m
≤40	$0.052 \times W$	$0.123 \times W$
>40~80	$0.026 \times W$	$0.087 \times W$
80~180	$0.017 \times W$	$0.052 \times W$

## Sistema de ranuras en T y símbolos

### T Slot Símbolos

Piezas compatibles con diferentes ranura T

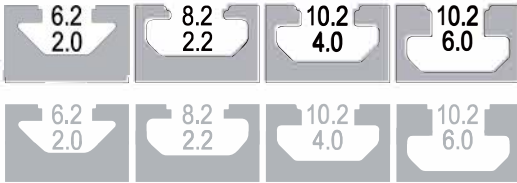

T Slot Sombolo	Corte transversal	Agujero central $\Phi$	Ancho de ranura	profundidad	Espesor de pared	Referencia
		5.0	6.2	6.0	2.0	CT15 CT20
		10.0	8.2	8.0	2.2	CT30
		12.0	10.2	11.0	4.0	CT40
		12.0	10.2	13.0	6.0	CT45 CT50 CT60

Perfil estructural CT15

CT151 5x152 Ranuras

El perfil de estructural CT15 con ranura en T de 6 mm está diseñado para construir conjuntos ligeros. Los perfiles PG15 se desarrollaron como complemento de los perfiles CT20 y CT30.  
 Selección de conectores: soporte de perfil angular, juego de soportes interiores, conector de barra lineal, etc.

15x15 2 ranuras

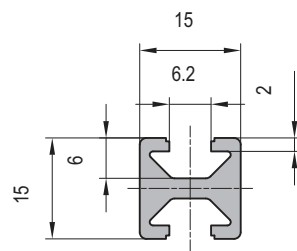
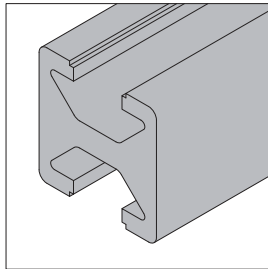

Description	Moment of Inertia $I_x(\text{cm}^4)$	Moment of Inertia $I_y(\text{cm}^4)$	Moment of Resistance $W_x(\text{cm}^3)$	Moment of Resistance $W_y(\text{cm}^3)$	Mass (kg/m)
	0.2	0.4	0.3	0.5	0.4

## Perfil estructural CT20

El perfil estructural CT20 con ranura en T de 6 mm está diseñado para construir ensamblajes ligeros como estructuras de bastidor de precisión, vitrinas, etc.

Selección de conectores: soporte de perfil angular, juego de soportes interiores, conector de barra lineal, etc.

20x20 4 ranuras

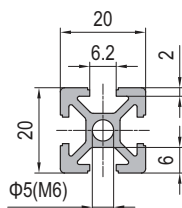
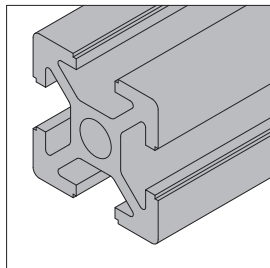

Momento de inercia	$I_x(\text{cm}^4)$	0.8
Momento de inercia	$I_y(\text{cm}^4)$	0.8
Momento de resistencia	$W_x(\text{cm}^3)$	0.8
Momento de resistencia	$W_y(\text{cm}^3)$	0.8
Masa	(kg/m)	0.5

20x40 6 ranuras

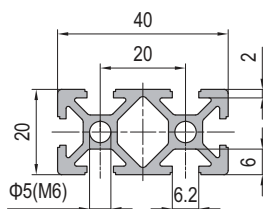
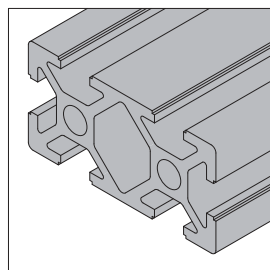

Momento de inercia	$I_x(\text{cm}^4)$	1.4
Momento de inercia	$I_y(\text{cm}^4)$	5.1
Momento de resistencia	$W_x(\text{cm}^3)$	1.4
Momento de resistencia	$W_y(\text{cm}^3)$	2.5
Masa	(kg/m)	0.9

20x60 8 ranuras

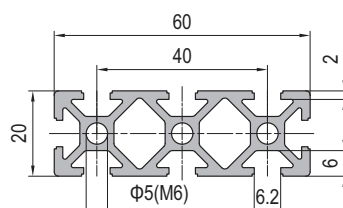
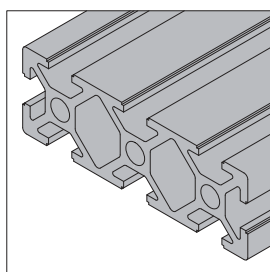

Momento de inercia	$I_x(\text{cm}^4)$	2.0
Momento de inercia	$I_y(\text{cm}^4)$	15.8
Momento de resistencia	$W_x(\text{cm}^3)$	2.0
Momento de resistencia	$W_y(\text{cm}^3)$	5.3
Masa	(kg/m)	1.3

20x80 10 ranuras

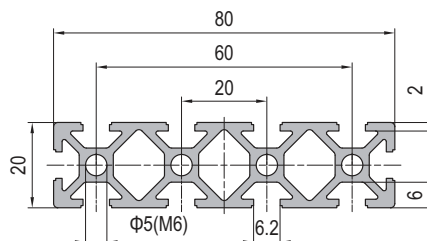
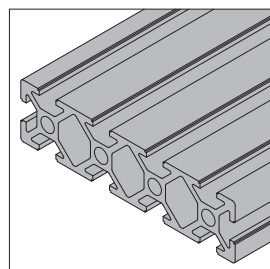

Momento de inercia	$I_x(\text{cm}^4)$	2.6
Momento de inercia	$I_y(\text{cm}^4)$	35.9
Momento de resistencia	$W_x(\text{cm}^3)$	2.6
Momento de resistencia	$W_y(\text{cm}^3)$	9.2
Masa	(kg/m)	1.7





### Perfil estructural CT30

El perfil estructural CT30 con ranura en T de 8 mm está diseñado para construir conjuntos de peso medio como carros, estaciones de trabajo, tabiques, bastidores de exposición, etc. El perfil 30 x 60 x 60 está diseñado para construir vitrinas y estanterías. También hay disponibles perfiles de radio para hacer los montajes más atractivos.

Selección de conectores: conector de anclaje, soporte de fundición a presión, soporte de perfil angular, juego de soportes interiores, conector de barra lineal, etc.

30x30 4 ranuras

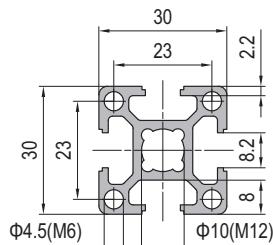
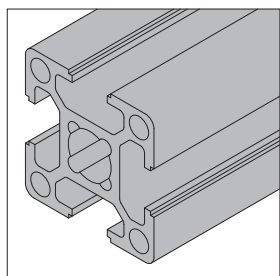

Momento de inercia	$I_x(\text{cm}^4)$	2.9
Momento de inercia	$I_y(\text{cm}^4)$	2.9
Momento de resistencia	$W_x(\text{cm}^3)$	2
Momento de resistencia	$W_y(\text{cm}^3)$	1.9
Masa	(kg/m)	0.9

30x60 6 ranuras

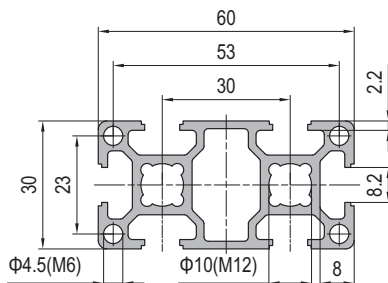
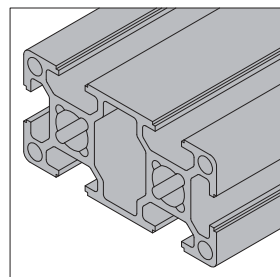

Momento de inercia	$I_x(\text{cm}^4)$	5.3
Momento de inercia	$I_y(\text{cm}^4)$	19.9
Momento de resistencia	$W_x(\text{cm}^3)$	3.5
Momento de resistencia	$W_y(\text{cm}^3)$	6.7
Masa	(kg/m)	1.6

30x90 8 ranuras

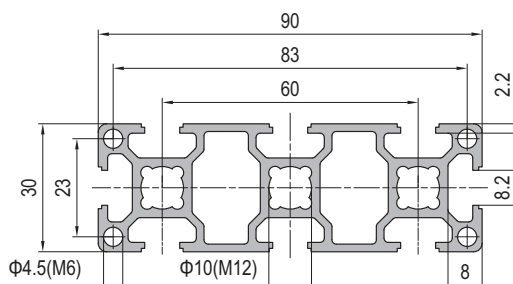
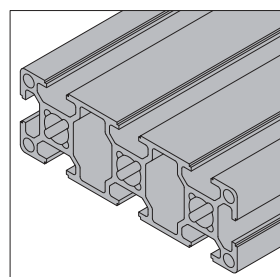

Momento de inercia	$I_x(\text{cm}^4)$	7.7
Momento de inercia	$I_y(\text{cm}^4)$	62.0
Momento de resistencia	$W_x(\text{cm}^3)$	5.1
Momento de resistencia	$W_y(\text{cm}^3)$	13.8
Masa	(kg/m)	2.2

60x60 8 ranuras

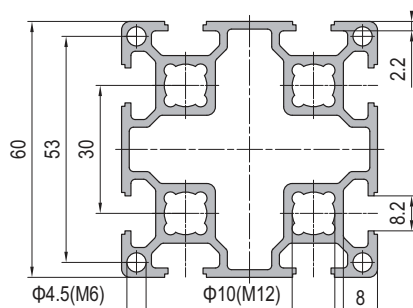
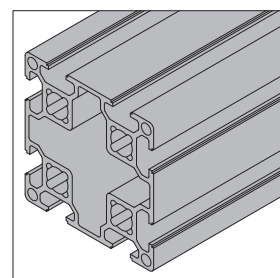

Momento de inercia	$I_x(\text{cm}^4)$	35.3
Momento de inercia	$I_y(\text{cm}^4)$	35.3
Momento de resistencia	$W_x(\text{cm}^3)$	11.8
Momento de resistencia	$W_y(\text{cm}^3)$	11.8
Masa	(kg/m)	2.5

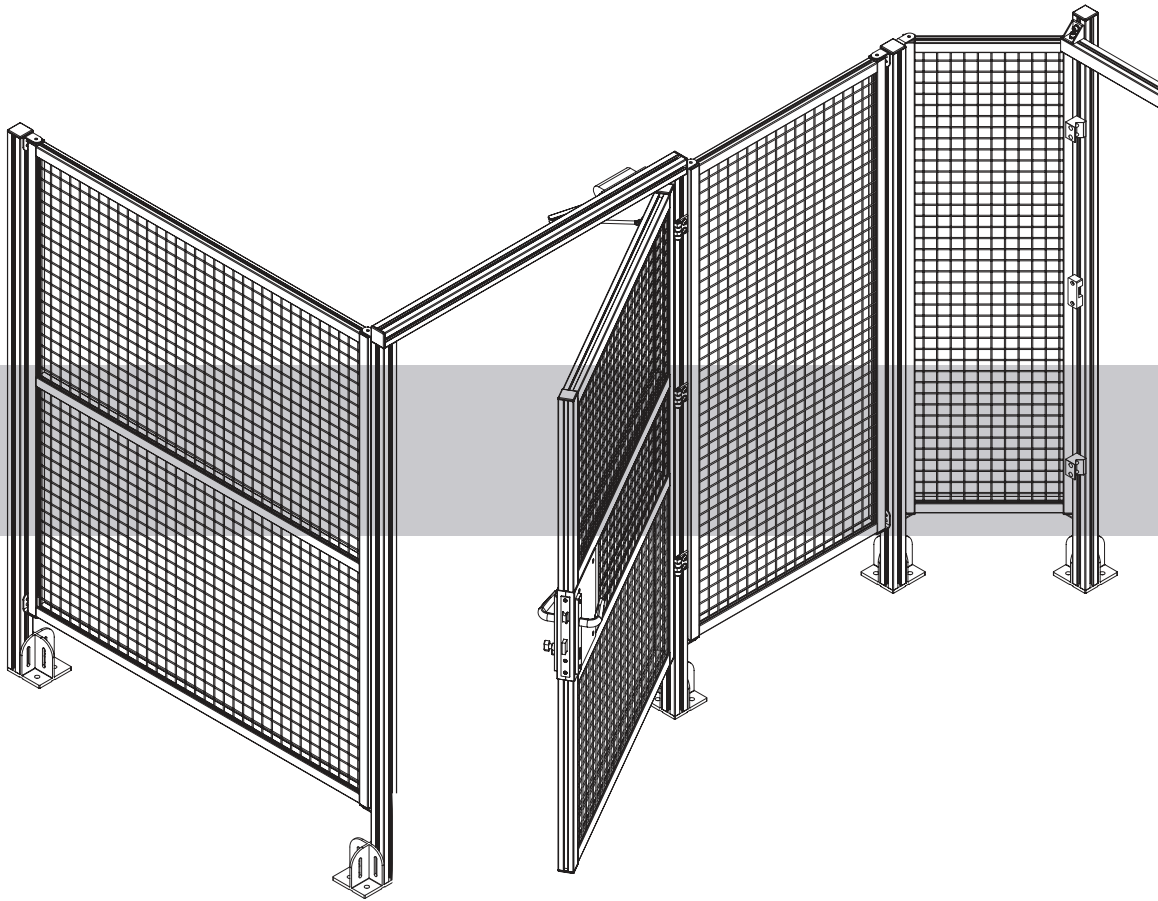

## Perfil estructural CT40

Los perfiles estructurales CT40 con ranura en T de 10 mm están diseñados para la construcción de montajes de peso medio a pesado, como estaciones de trabajo, bastidores de maquinaria, stands de exposiciones, montajes de cintas transportadoras, etc. Selección de conectores: conector de anclaje, soporte de fundición a presión, soporte de perfil angular, juego de soportes interiores, conector de barra lineal, etc.

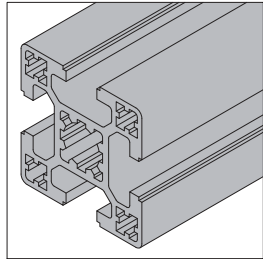

40x40 4 slots

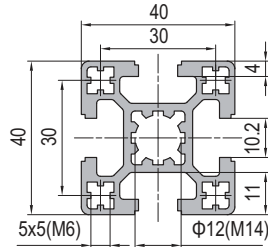

Momento de inercia	$I_x(\text{cm}^4)$	2.9
Momento de inercia	$I_y(\text{cm}^4)$	2.9
Momento de resistencia	$W_x(\text{cm}^3)$	2
Momento de resistencia	$W_y(\text{cm}^3)$	1.9
Masa	(kg/m)	0.9

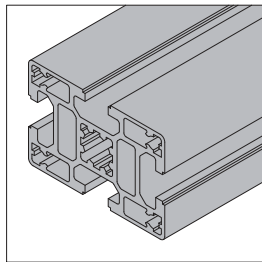

40x60 4 slots

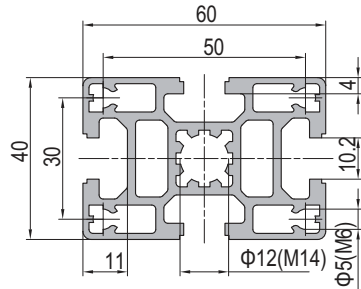

Momento de inercia	$I_x(\text{cm}^4)$	5.3
Momento de inercia	$I_y(\text{cm}^4)$	19.9
Momento de resistencia	$W_x(\text{cm}^3)$	3.5
Momento de resistencia	$W_y(\text{cm}^3)$	6.7
Masa	(kg/m)	1.6

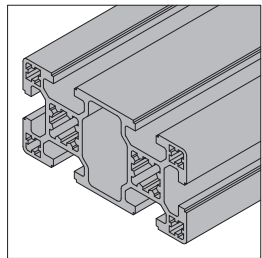

40x80 6 slots

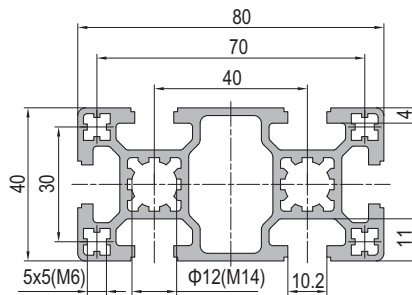

Momento de inercia	$I_x(\text{cm}^4)$	7.7
Momento de inercia	$I_y(\text{cm}^4)$	62.0
Momento de resistencia	$W_x(\text{cm}^3)$	5.1
Momento de resistencia	$W_y(\text{cm}^3)$	13.8
Masa	(kg/m)	2.2

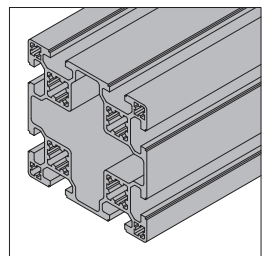

80x80 8 slots

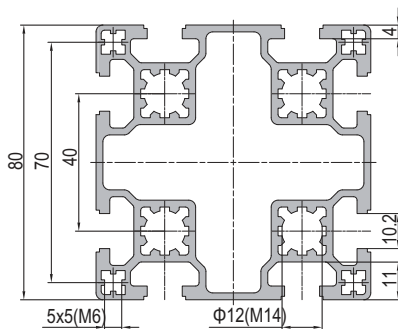

Momento de inercia	$I_x(\text{cm}^4)$	35.3
Momento de inercia	$I_y(\text{cm}^4)$	35.3
Momento de resistencia	$W_x(\text{cm}^3)$	11.8
Momento de resistencia	$W_y(\text{cm}^3)$	11.8
Masa	(kg/m)	2.5





## Perfil estructural CT45

Los perfiles estructurales PG45 con ranura en T de 10 mm están diseñados para la construcción de conjuntos de gran peso, como transportadores, líneas de producción, carros de trabajo, estanterías, etc. Selección de conectores: conector de anclaje, soporte de fundición a presión, soporte de perfil angular, juego de soportes interiores, conector de barra lineal, etc. .

45x45 4 slots

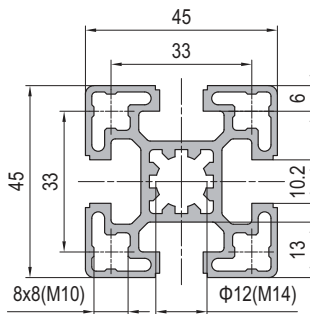
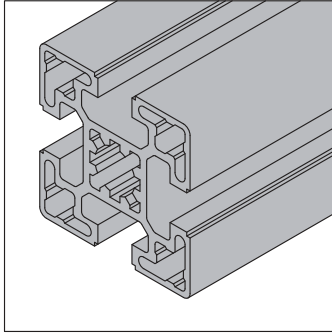

Momento de inercia	$I_x(\text{cm}^4)$	12.1
Momento de inercia	$I_y(\text{cm}^4)$	12.1
Momento de resistencia	$W_x(\text{cm}^3)$	5.4
Momento de resistencia	$W_y(\text{cm}^3)$	5.4
Masa	(kg/m)	1.8

45x90 6 slots

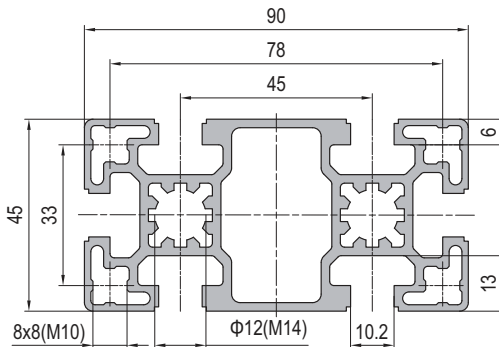
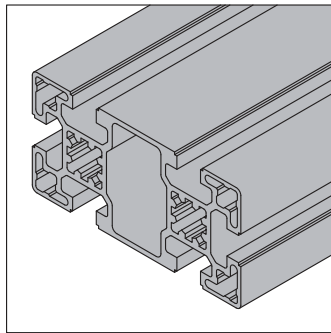

Momento de inercia	$I_x(\text{cm}^4)$	24.2
Momento de inercia	$I_y(\text{cm}^4)$	89.3
Momento de resistencia	$W_x(\text{cm}^3)$	10.8
Momento de resistencia	$W_y(\text{cm}^3)$	19.9
Masa	(kg/m)	3.2

90x90 L 8 slots

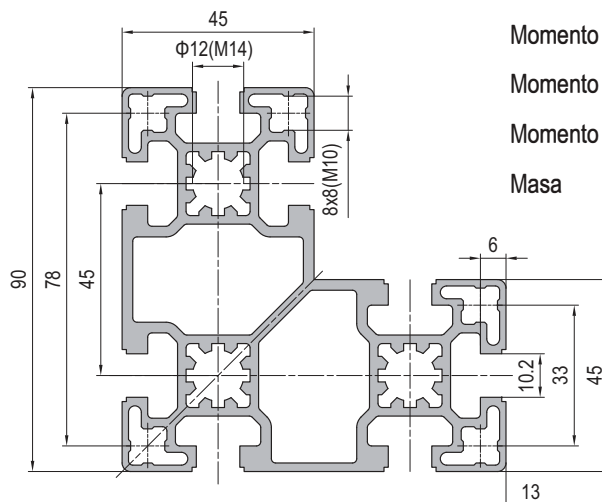
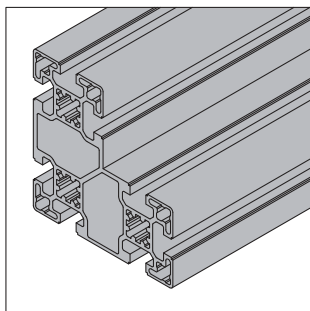

Momento de inercia	$I_x(\text{cm}^4)$	161.4
Momento de inercia	$I_y(\text{cm}^4)$	80.3
Momento de resistencia	$W_x(\text{cm}^3)$	25.6
Momento de resistencia	$W_y(\text{cm}^3)$	15.2
Masa	(kg/m)	4.6



### Perfil estructural CT50

El perfil estructural CT50 con ranura en T de 10 mm está diseñado para la construcción de conjuntos de gran peso. Los perfiles CT50 se desarrollaron para complementar los perfiles CT40 y CT45.

Selección de conectores: soporte de perfil angular, juego de soportes interiores, conector de barra lineal, etc. .

50x50 4 slots

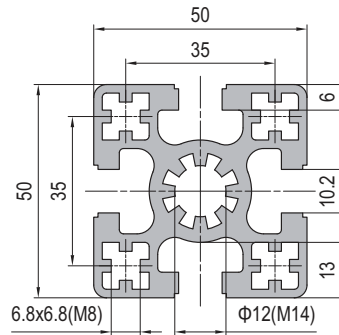
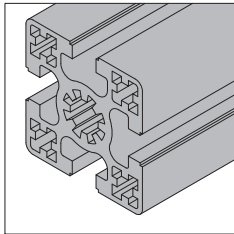

Momento de inercia	$I_x(\text{cm}^4)$	25
Momento de inercia	$I_y(\text{cm}^4)$	25
Momento de resistencia	$W_x(\text{cm}^3)$	10
Momento de resistencia	$W_y(\text{cm}^3)$	10
Masa	(kg/m)	3

50x100 6 slots

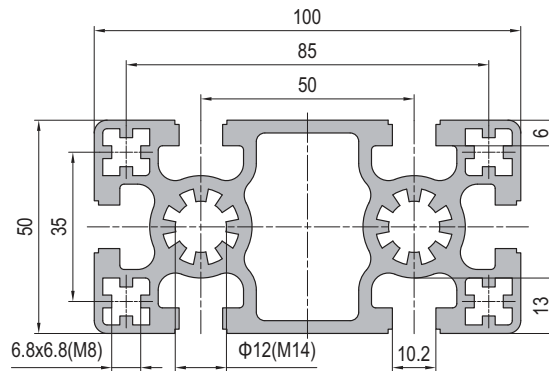
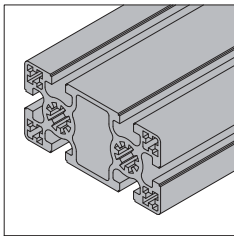

Momento de inercia	$I_x(\text{cm}^4)$	46.2
Momento de inercia	$I_y(\text{cm}^4)$	184.4
Momento de resistencia	$W_x(\text{cm}^3)$	18.5
Momento de resistencia	$W_y(\text{cm}^3)$	36.9
Masa	(kg/m)	5

100x100 8 slots

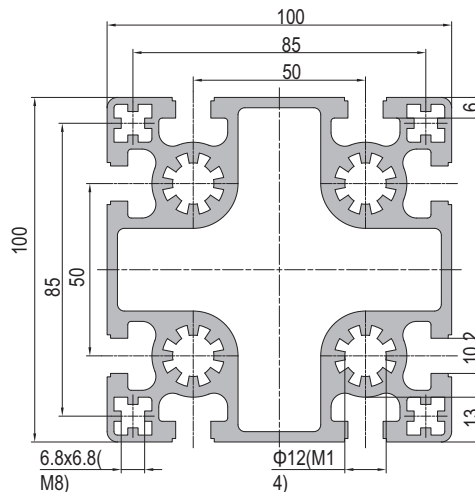
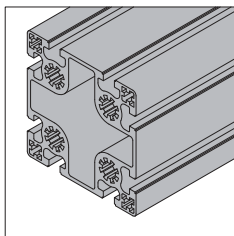

Momento de inercia	$I_x(\text{cm}^4)$	331.1
Momento de inercia	$I_y(\text{cm}^4)$	331.1
Momento de resistencia	$W_x(\text{cm}^3)$	66.2
Momento de resistencia	$W_y(\text{cm}^3)$	66.2
Masa	(kg/m)	8.5



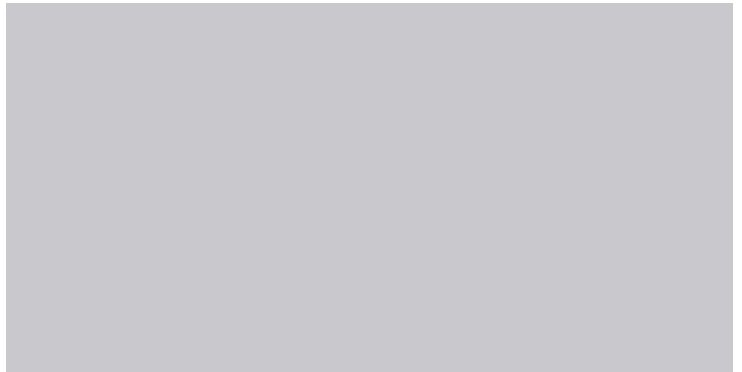

# Coltronic

## ACCESORIOS



Connecting Elements

Anchor Connector-PG30-Standard (Model P)

Material : zinc plated steel

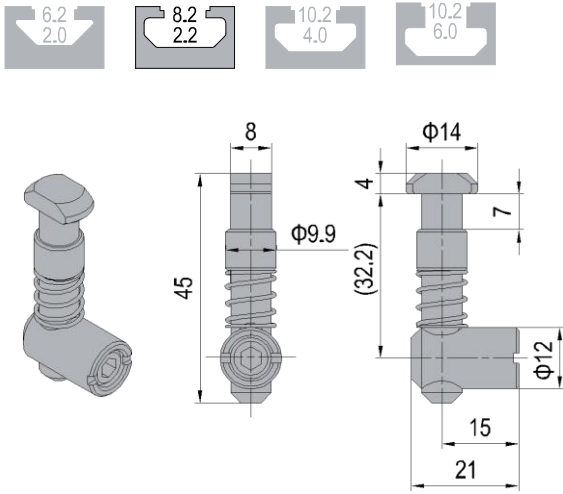

Description		Mass (g/unit)	
Anchor Connector PG30 Standard (Model P)			

Connecting Elements

Anchor Connector-PG30-Standard (Model C)

Material : zinc plated steel

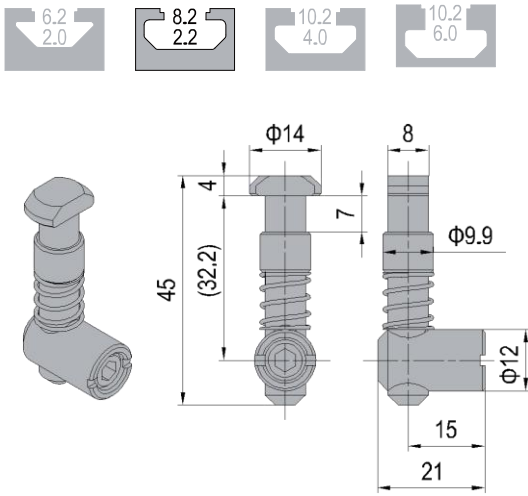

Description		Mass (g/unit)	
Anchor Connector PG30 Standard (Model C)			



Connecting Elements

Anchor Connector-PG30-Oblique (Model P)

Material : zinc plated steel

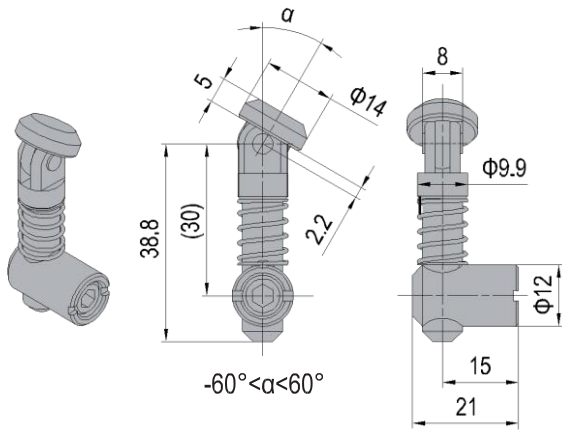
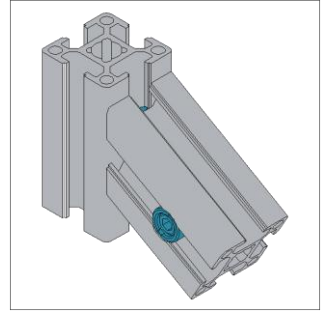

A

Description		Mass (g/unit)	
Anchor Connector PG30 Oblique (Model P)			

Connecting Elements

Anchor Connector-PG30-Oblique (Model C)

Material : zinc plated steel

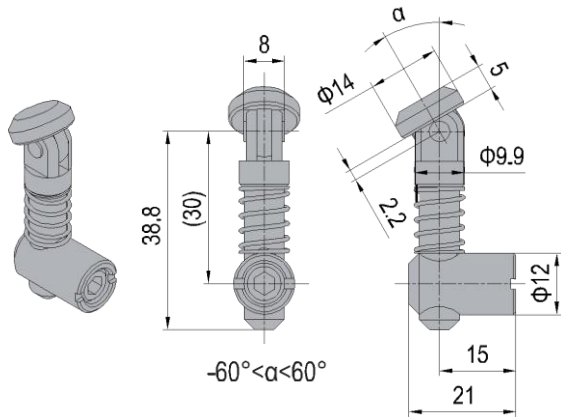
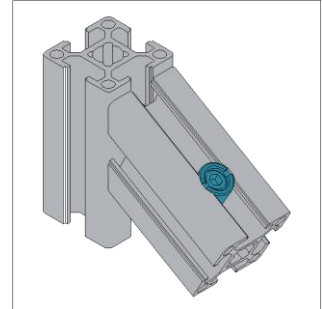

Description		Mass (g/unit)	
Anchor Connector PG30 Oblique (Model C)			

Connecting Elements

Anchor Connector-PG30-Miter (Model P)

Material : zinc plated steel

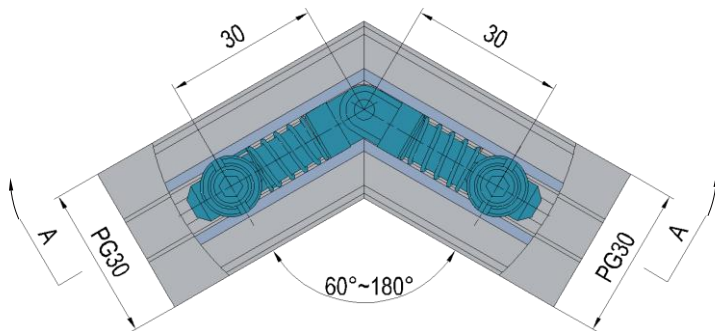
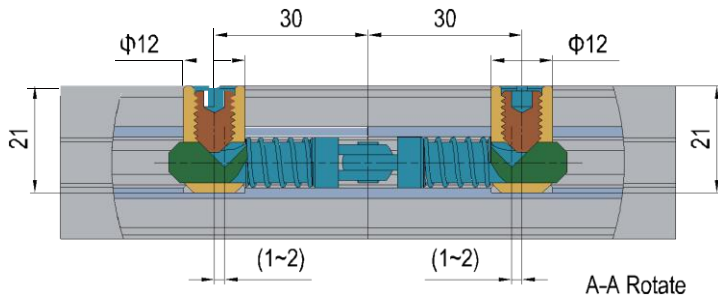
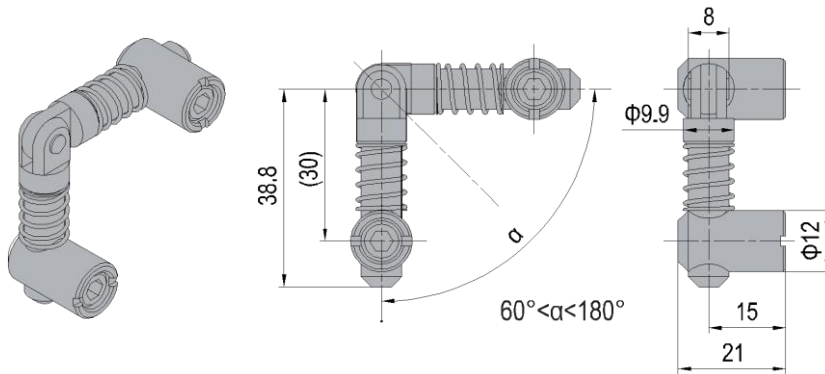
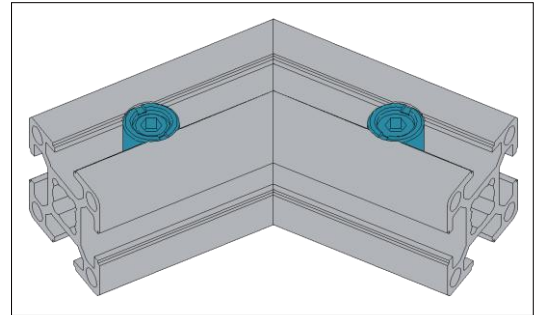

Description	Mass (g/unit)
Anchor Connector PG30 Miter (Model P)	

Connecting Elements

Anchor Connector-PG30-Miter (Model C)

Material : zinc plated steel

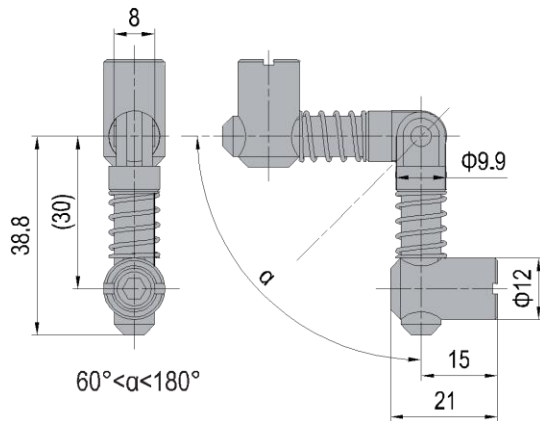
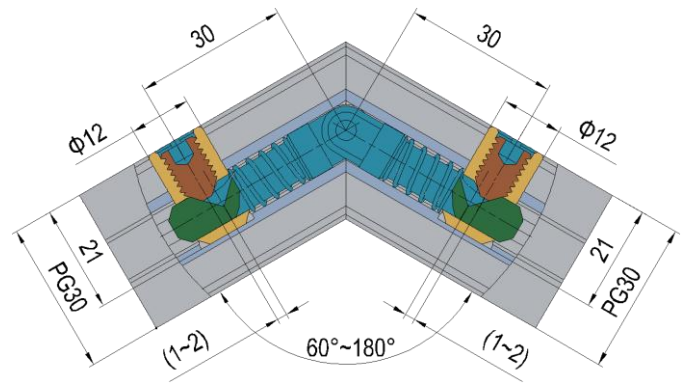
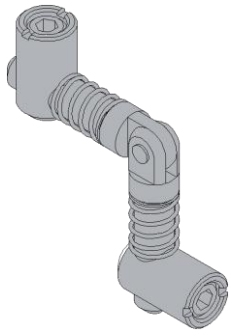
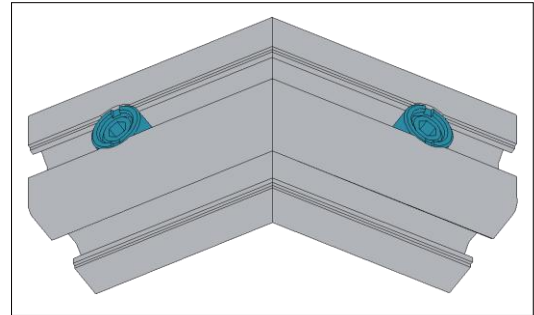

Description	Material	Mass (g/unit)	
Anchor Connector PG30 Miter (Model C)			

Connecting Elements

Anchor Connector-PG40-Universal

Material : zinc plated steel

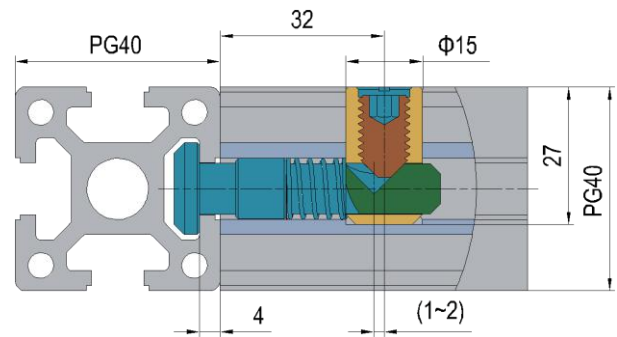
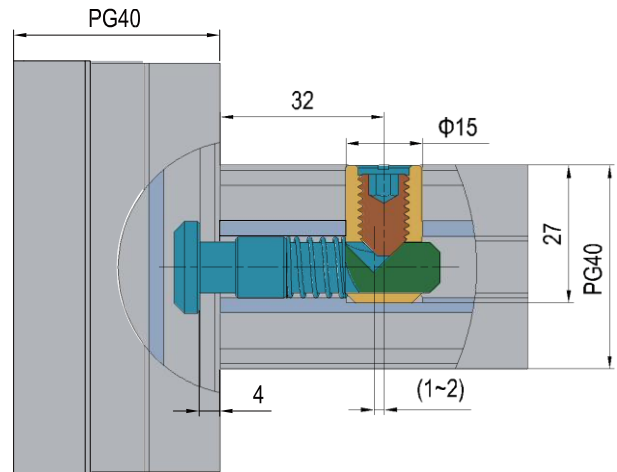
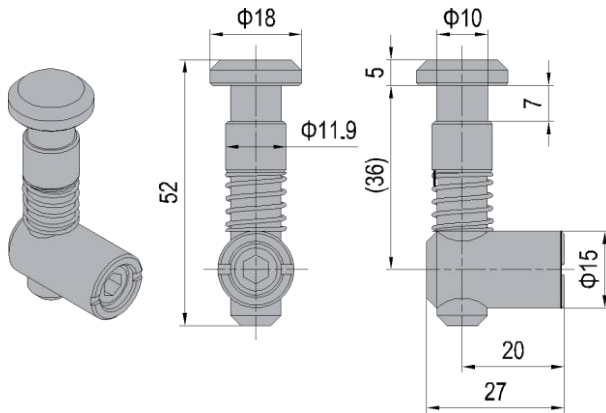
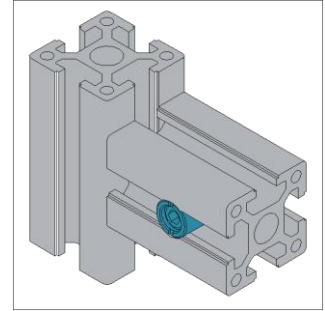
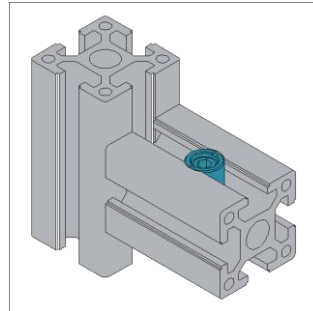

tion		Mass (g/unit)	
Anchor Connector PG40 Universal			



Connecting Elements

Anchor Connector-PG40-Standard (Model P)

Material : zinc plated steel

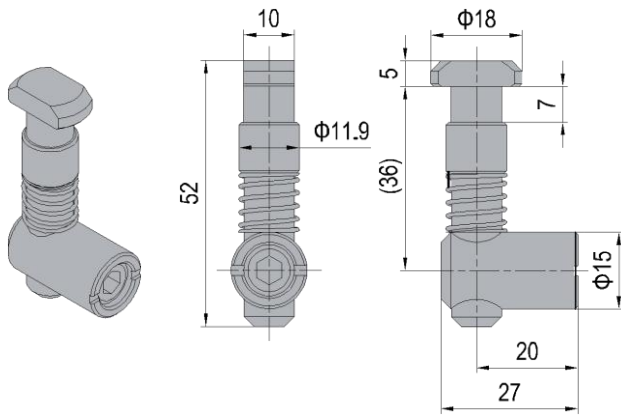
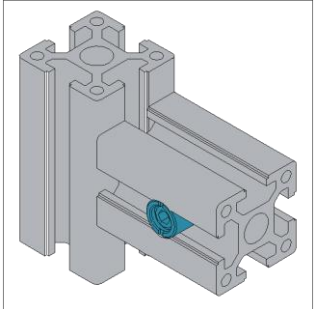

Description		Mass (g/unit)	
Anchor Connector PG40 Standard (Model P)			

Connecting Elements

Anchor Connector-PG40-Standard (Model C)

Material : zinc plated steel

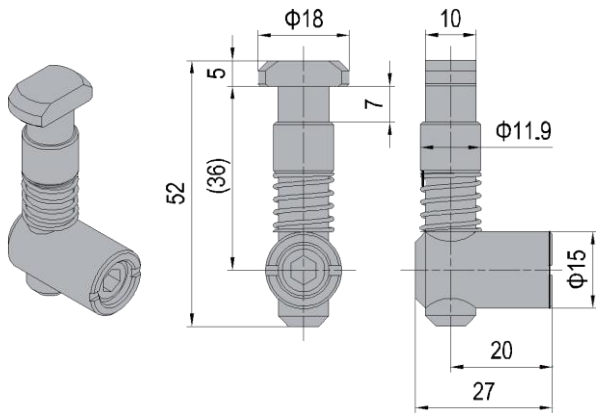
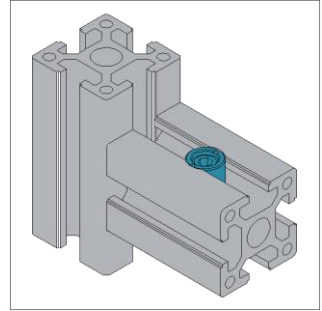

Description		Mass (g/unit)	
Anchor Connector-PG30-Standard (Model C)			

Connecting Elements

Anchor Connector-PG40-Oblique (Model P)

Material : zinc plated steel

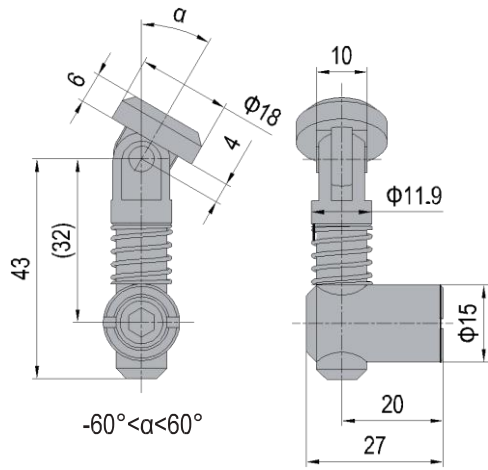
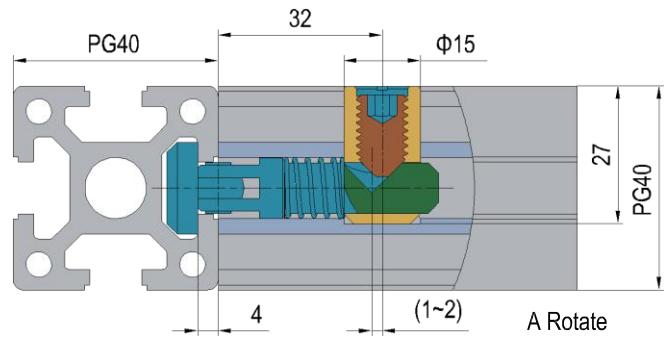
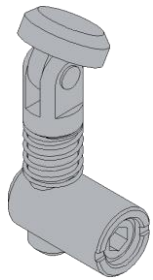
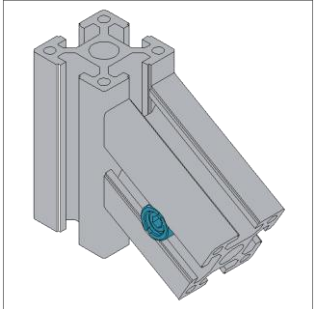

Description		Mass (g/unit)	
Anchor Connector-PG40-Oblique (Model P)			

Connecting Elements

Anchor Connector-PG40-Oblique (Model C)

Material : zinc plated steel

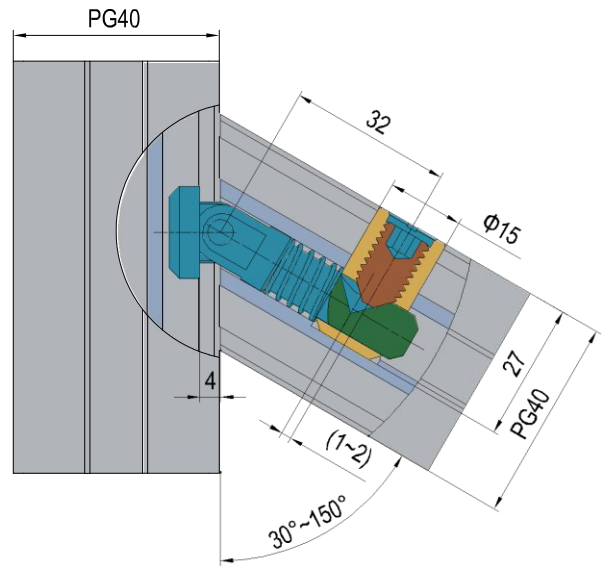
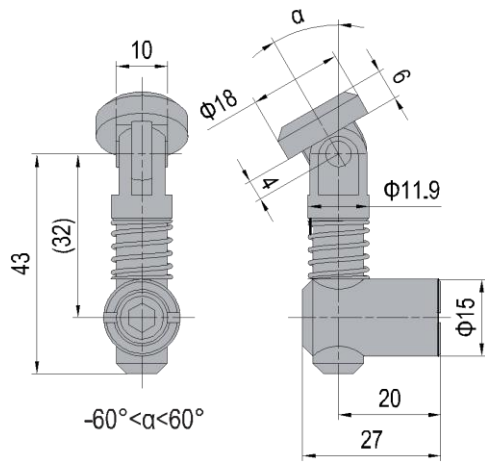
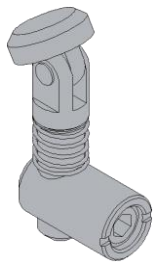
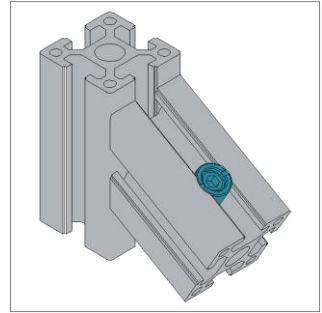

Description	Material	Mass (g/unit)	
Anchor Connector PG40 Oblique (Model C)			

Connecting Elements

Anchor Connector-PG40-Miter (Model P)

Material : zinc plated steel

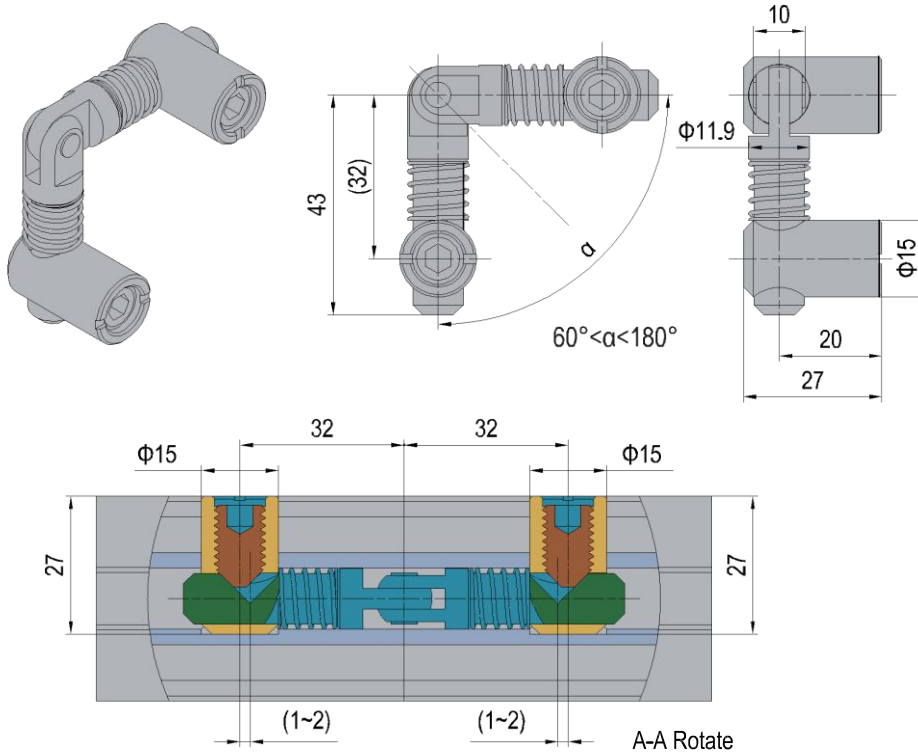
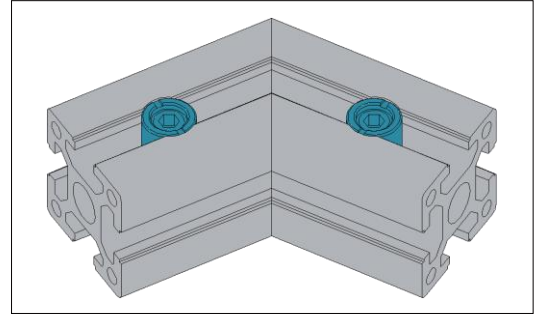

		Mass (g/unit)	
Anchor Connector PG40 Miter (Model P)			



Connecting Elements

Anchor Connector-PG40-Miter (Model C)

Material : zinc plated steel

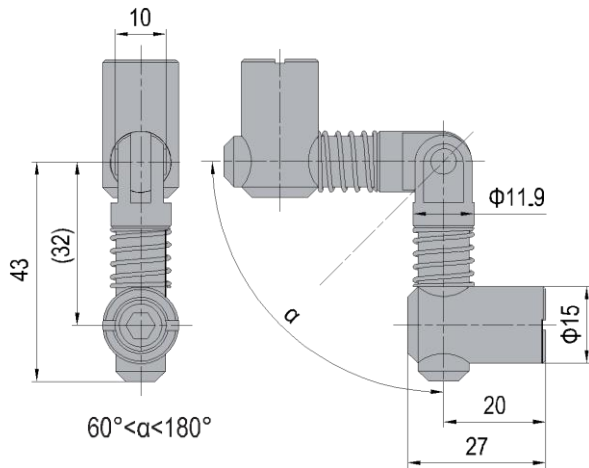
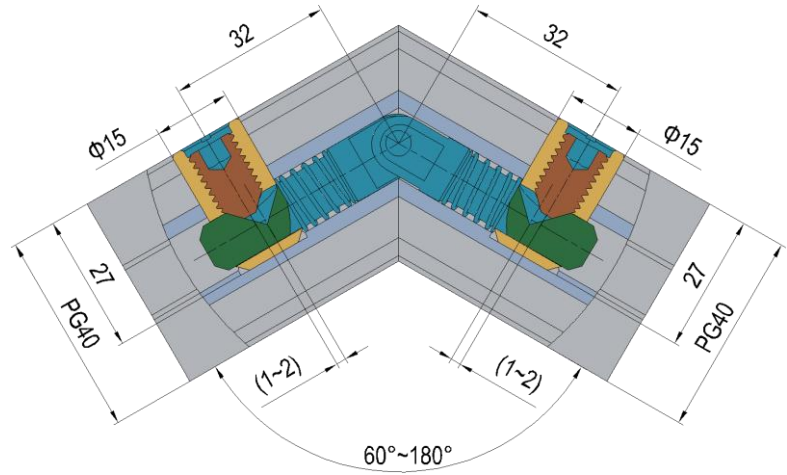
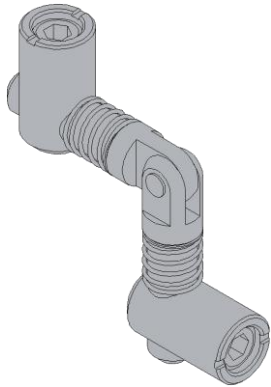
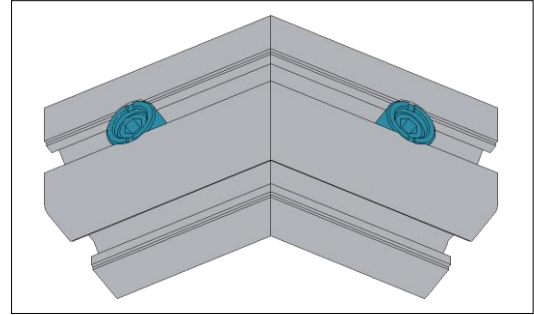

tlon		Mass (g/unlt)	
Anchor Connector PG40 Miter (Model C)			

Connecting Elements

Anchor Connector-PG40-Universal

Material : zinc plated steel

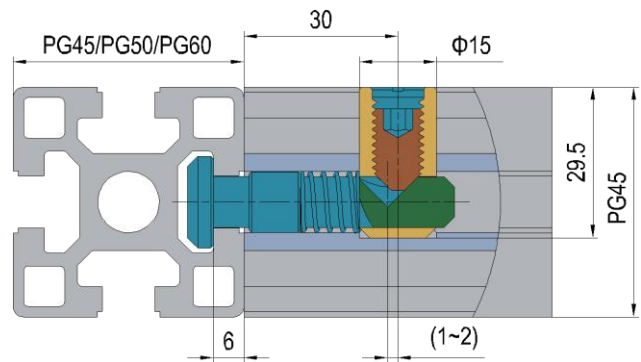
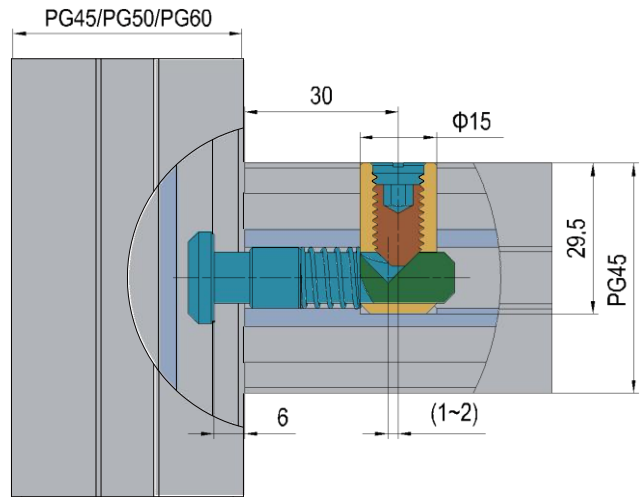
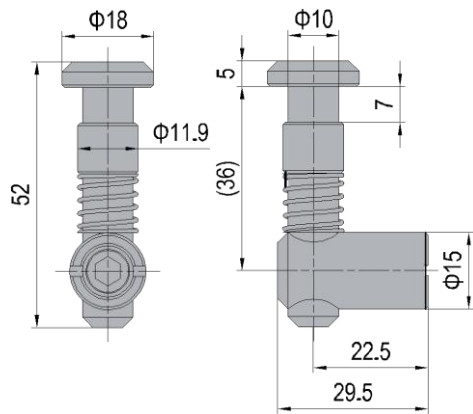
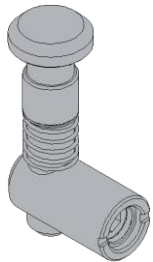
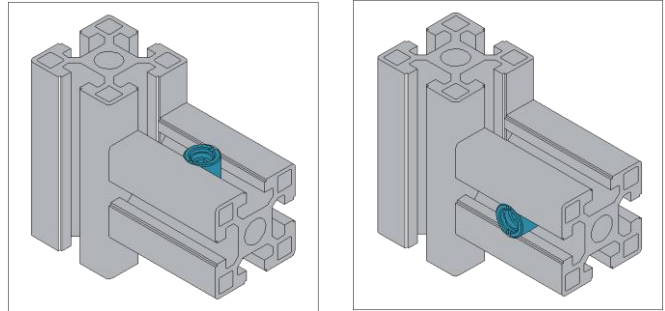

tion		Mass (g/unit)	
Anchor Connector PG45 Universal			

Connecting Elements

Anchor Connector-PG45-Standard (Model P)

Material : zinc plated steel

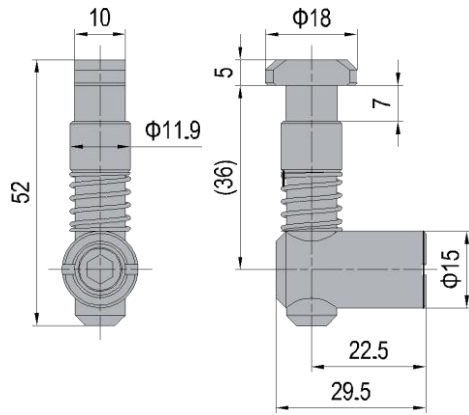
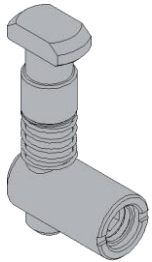
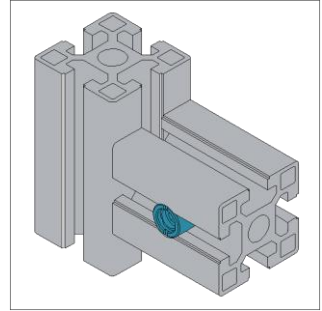

Description		Mass (g/unit)	
Anchor Connector-PG40-Standard (Model P)			

Connecting Elements

Anchor Connector-PG30-Standard (Model C)

Material : zinc plated steel

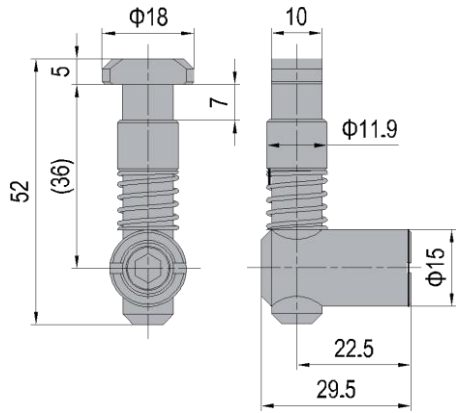
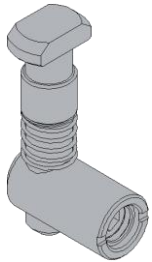
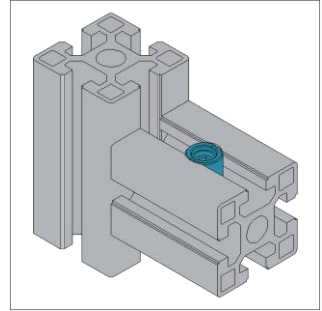

Description		Mass (g/unit)	
Anchor Connector-PG30-Standard (Model C)			

Connecting Elements

Anchor Connector-PG45-Oblique (Model P)

Material : zinc plated steel

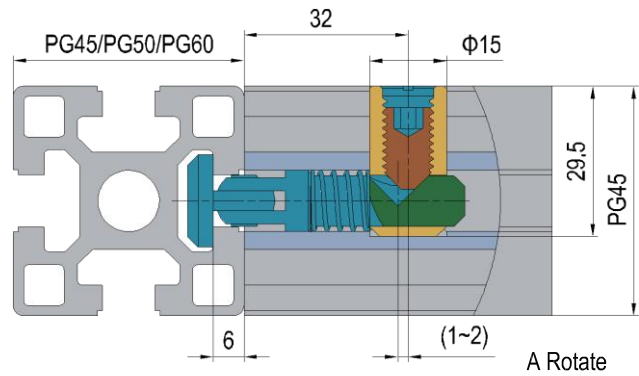
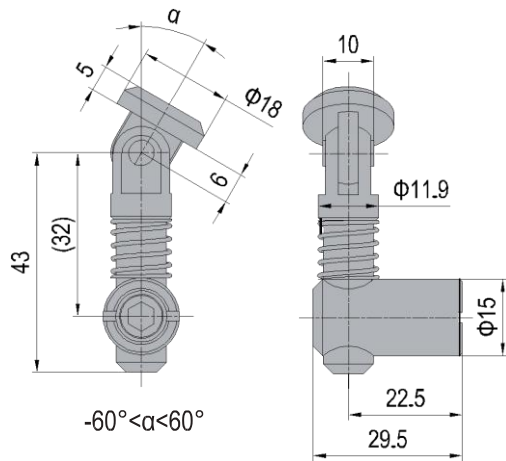
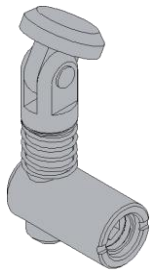
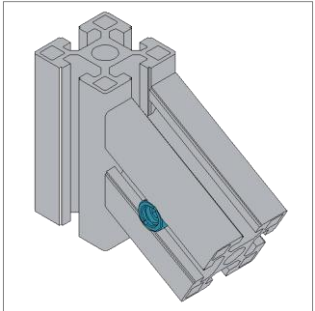

Description		Mass (g/unit)	
Anchor Connector PG45 Oblique (Model P)			



Connecting Elements

Anchor Connector-PG45-Oblique (Model C)

Material : zinc plated steel

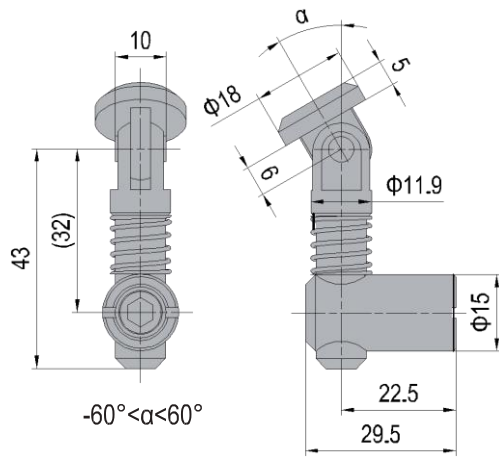
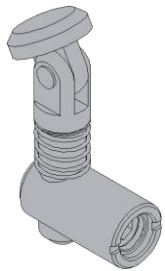
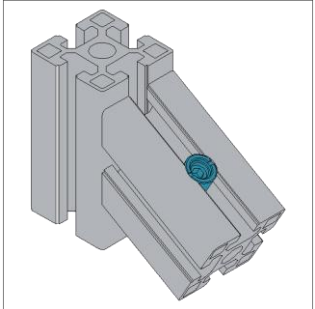

Description		Mass (g/unit)	
Anchor Connector PG45 Oblique (Model C)			

Connecting Elements

Anchor Connector-PG45-Miter (Model P)

Material : zinc plated steel

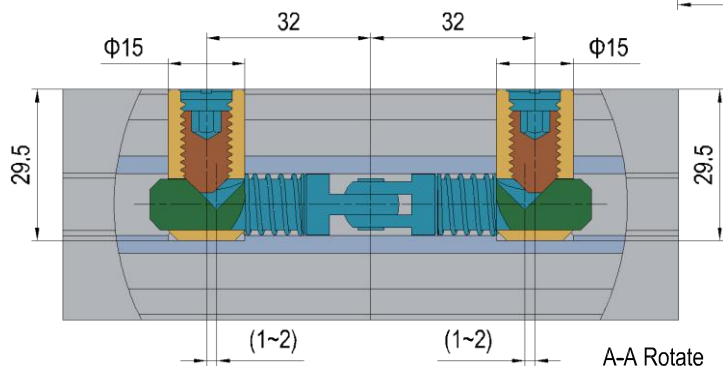
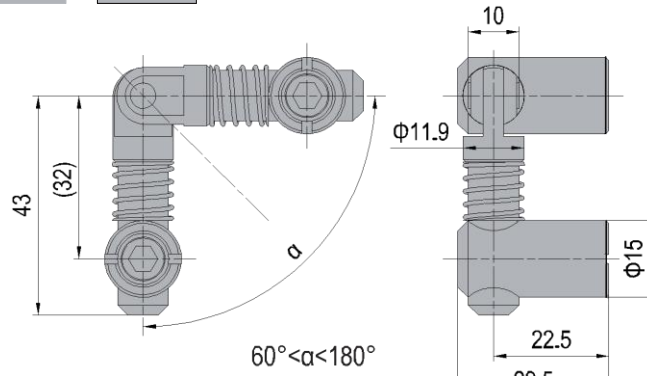
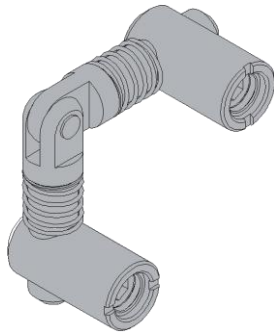
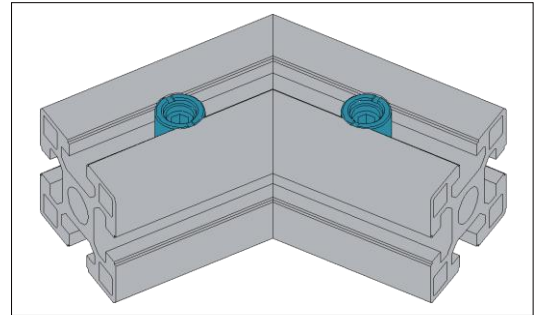

		Mass (g/unit)	
Anchor Connector PG45 Miter (Model P)			

Connecting Elements

Anchor Connector-PG45-Miter (Model C)

Material : zinc plated steel

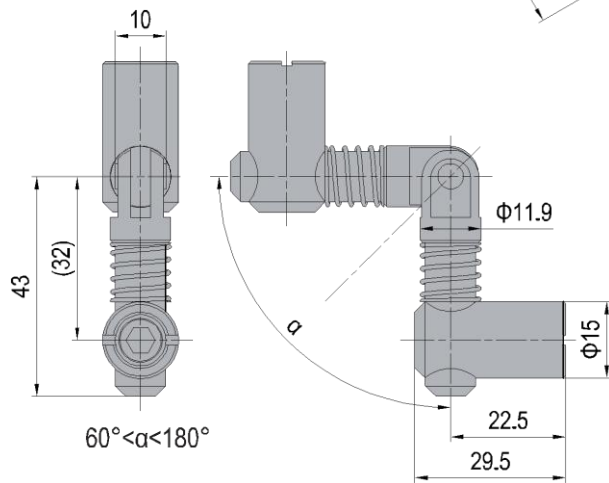
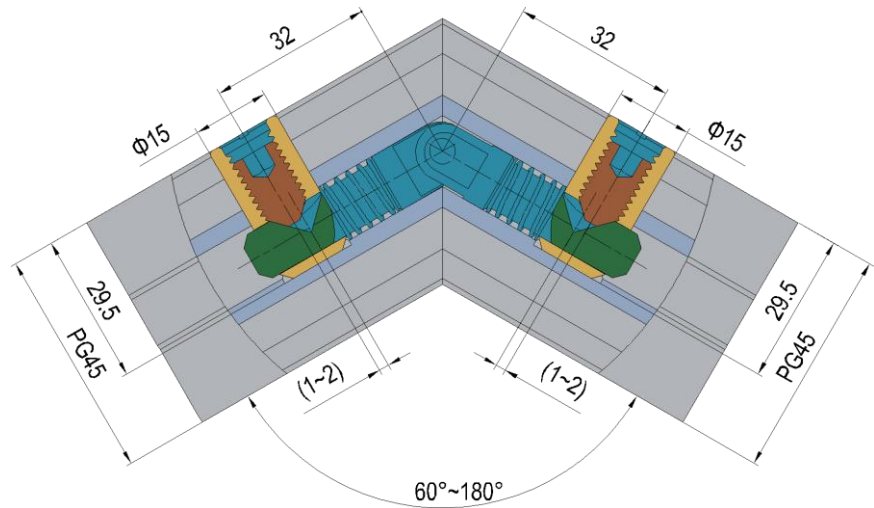
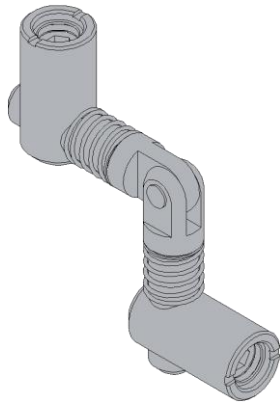
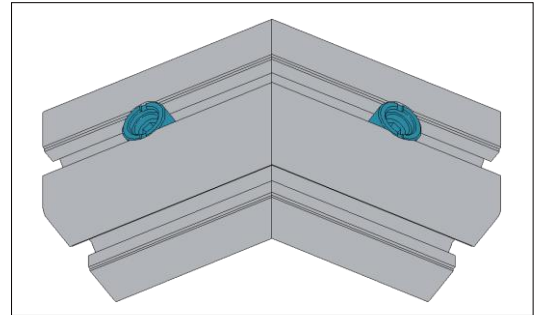

		Mass (g/unit)	
Anchor Connector-PG40-Miter (Model C)			

Connecting Elements

Die Cast Bracket-PG30-30x30

Material : die cast aluminium alloy

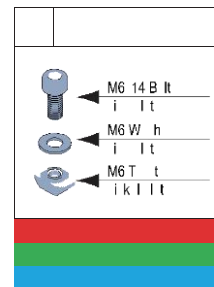
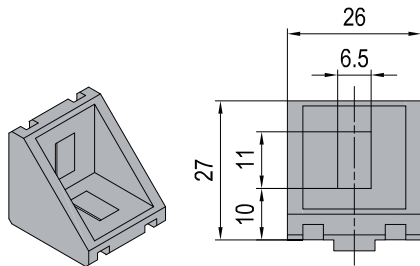
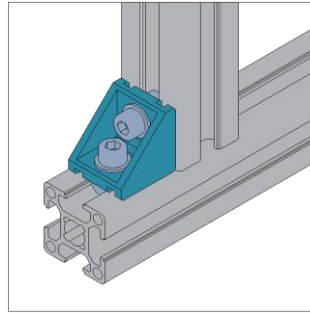

	Fastening Set		
Die Cast bracket PG30 30x30 (			3 21 30 3030
Die Cast bracket PG30 30x30 (set A)			3 21 30 3030 STA
Die Cast bracket PG30 30x30 (set B)			3 21 30 3030 STB

Connecting Elements

Die Cast Bracket-PG30-30x60

Material : die cast aluminium alloy

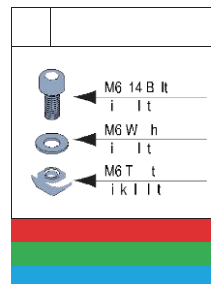
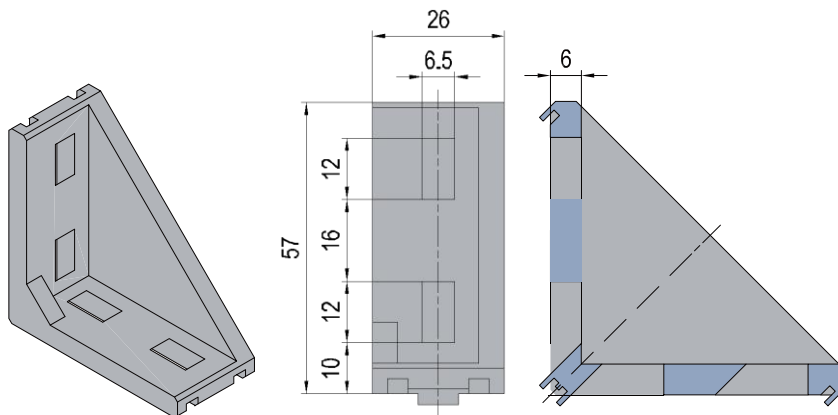
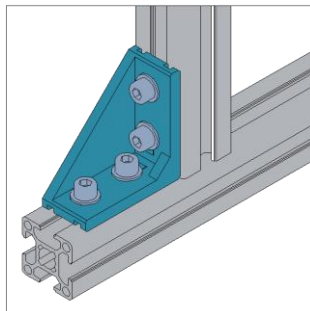

tion	Fastening Set	
Die Cast Bracket PG30 30x30 (		3 21 30 3060
Die Cast bracket PG30 30x60 (set A)		3 21 30 3060 STA
Die Cast bracket PG30 30x30 (set B)		3 21 30 3060 STB

Connecting Elements

Die Cast Bracket-PG30-60x60

Material : die cast aluminium alloy

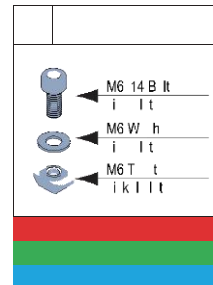
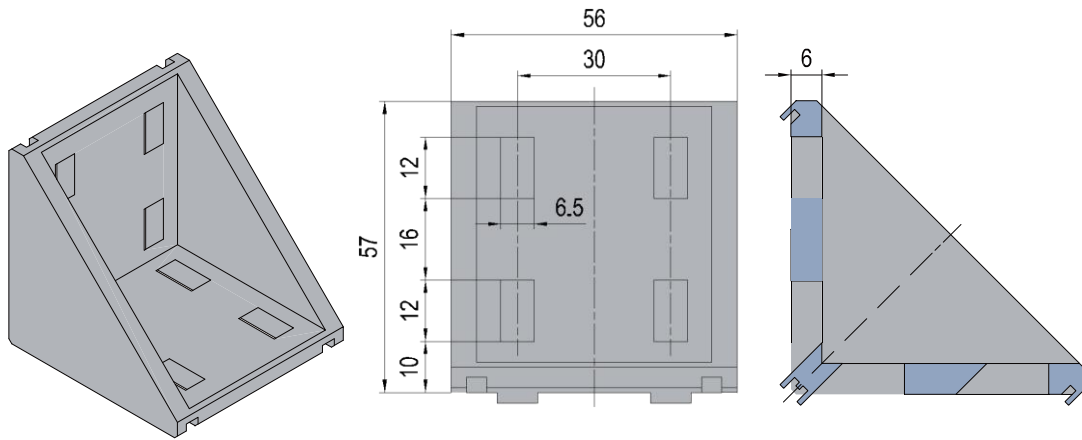
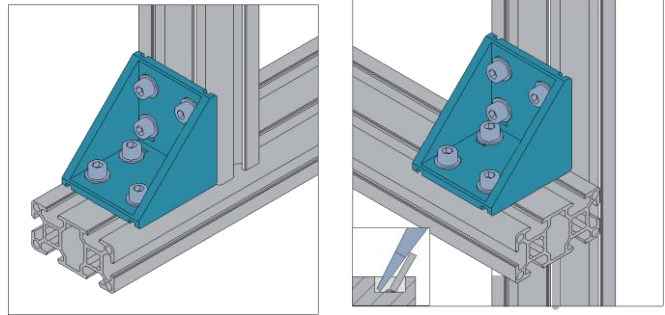

	Fastening Set	
Die Cast bracket PG30 60x60 (		3 21 30 6060
Die Cast bracket PG30 60x60 (set A)		3 21 30 6060 STA
Die Cast bracket PG30 30x30 (set B)		3 21 30 6060 STB



Connecting Elements

Die Cast Bracket-PG40-40x40

Material : die cast aluminium alloy

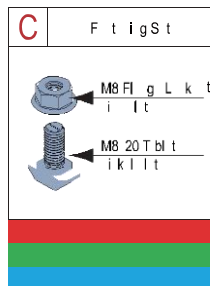
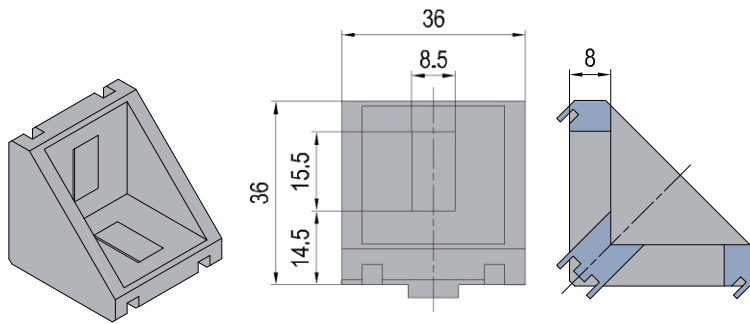
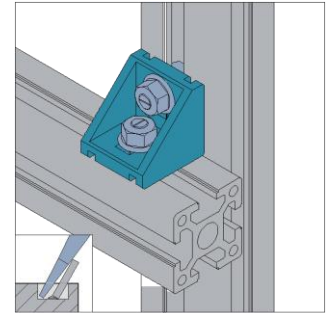
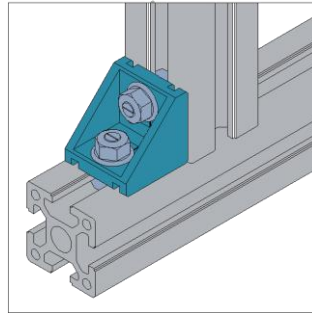

D F

tion	Fastening Set		
Die Cast Bracket PG40 40x40 (			
Die Cast Bracket PG40 40x40 (set C)			3 21 40 4040 STC
Die Cast Bracket PG40 40x40 (set D)			3 21 40 4040 STD
Die Cast bracket PG30 30x30 (set b)			

Connecting Elements

Die Cast Bracket-PG40-40x80

Material : die cast aluminium alloy

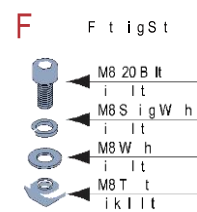
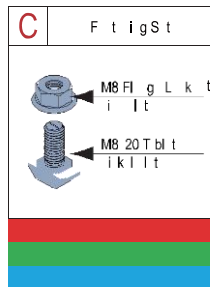
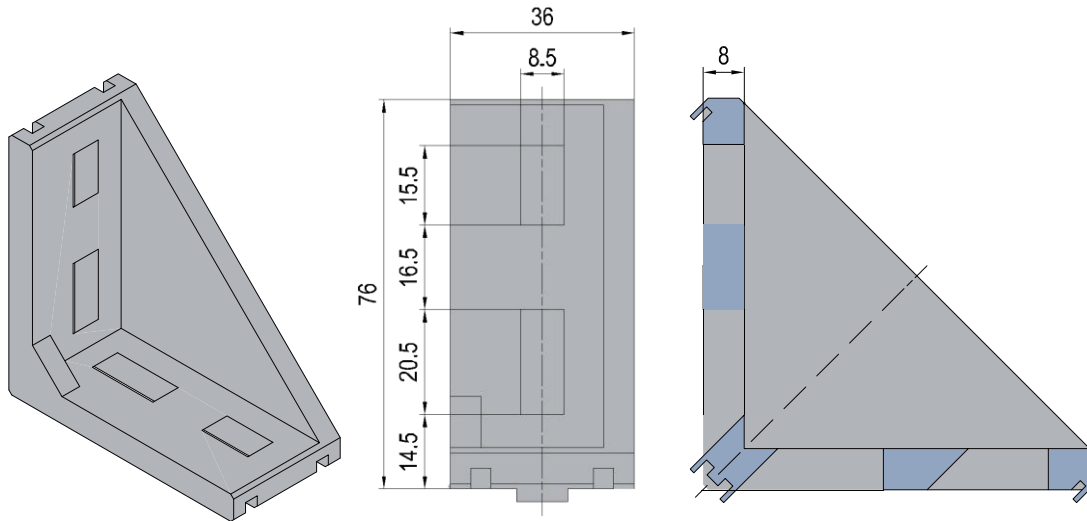
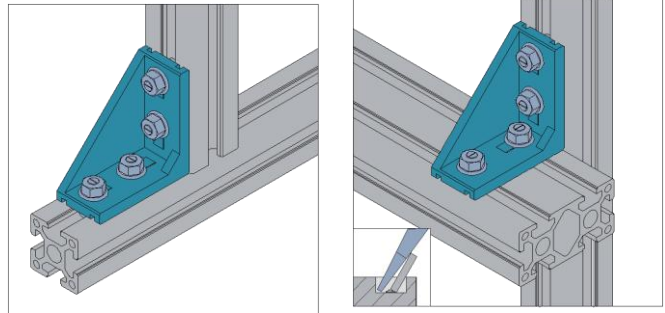

	Fastening Set		
Die Cast Bracket PG40 40x80 (			
Die Cast Bracket PG40 40x40 (set C)			3 21 40 4080 STC
Die Cast Bracket PG40 40x80 (set F)			3 21 40 4080 STF
Die Cast Bracket PG40 40x80 (set G)			3 21 40 4080 STG

Connecting Elements

Die Cast Bracket-PG40-80x80

Material : die cast aluminium alloy

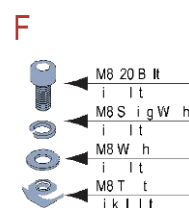
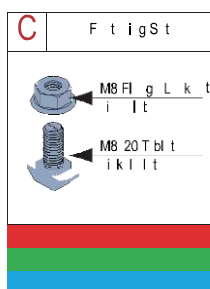
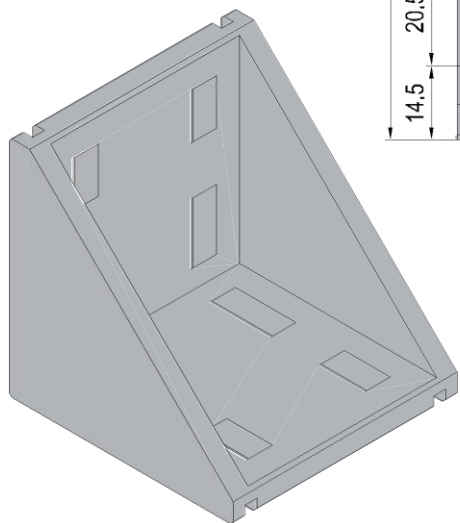
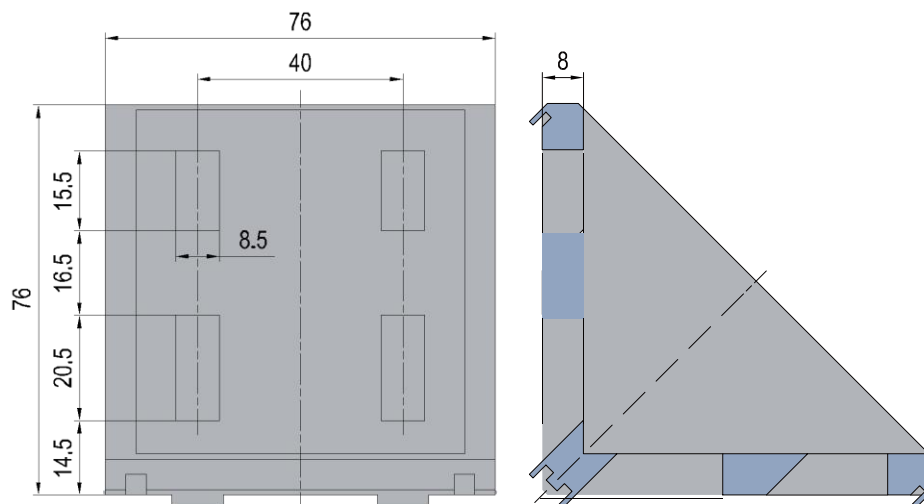
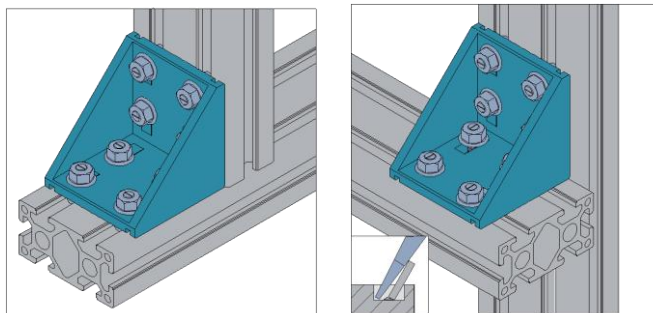

	Fastening Set	
Die Cast Bracket PG30 30x30 (		3 21 40 8080
Die Cast Bracket PG40 80x80 (set C)		3 21 40 8080 STC
Die Cast Bracket PG40 80x80 (set F)		3 21 40 8080 STF
Die Cast Bracket PG40 40x80 (set G)		3 21 40 8080 STG

Connecting Elements

Die Cast Bracket-PG45-45x45

Material : die cast aluminium alloy

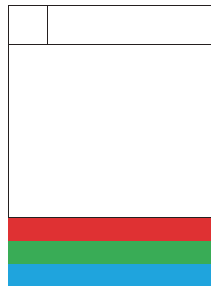
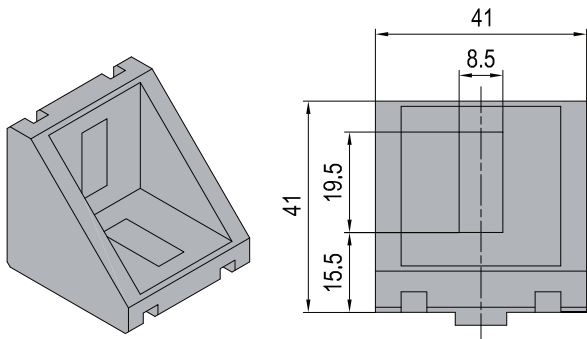
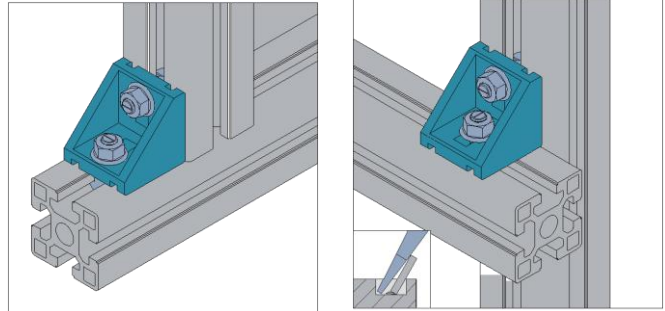

	Fastening Set		
Die Cast bracket PG45 45x45 (			
Die Cast bracket PG40 40x40 (set C)			
Die Cast bracket PG45 45x45 (set J)			3 21 45 4545 STJ
Die Cast bracket PG30 30x30 (set b)			

Connecting Elements

Die Cast Bracket-PG45-45x90

Material : die cast aluminium alloy

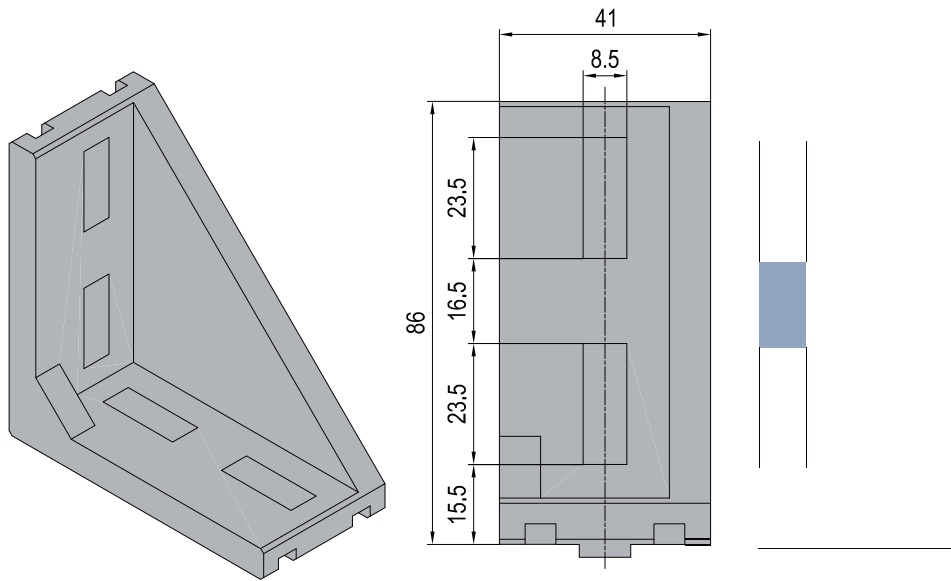
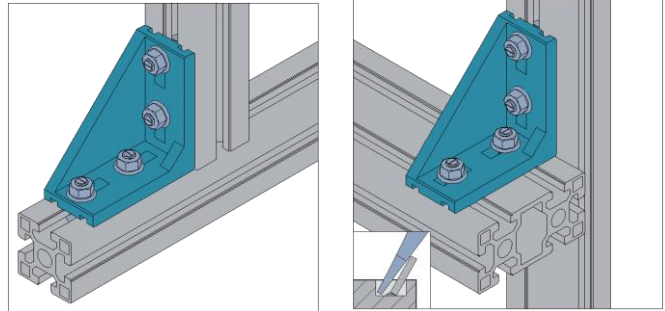

	Fastening Set		
Die Cast bracket PG45 45x90 (			
Die Cast bracket PG45 45x90 (set H)			3 21 45 4590 STH
Die Cast bracket PG45 45x45 (set J)			3 21 45 4590 STJ
Die Cast bracket PG45 45x90 (set K)			3 21 45 4590 STK

Connecting Elements

Die Cast Bracket-PG45-90x90

Material : die cast aluminium alloy

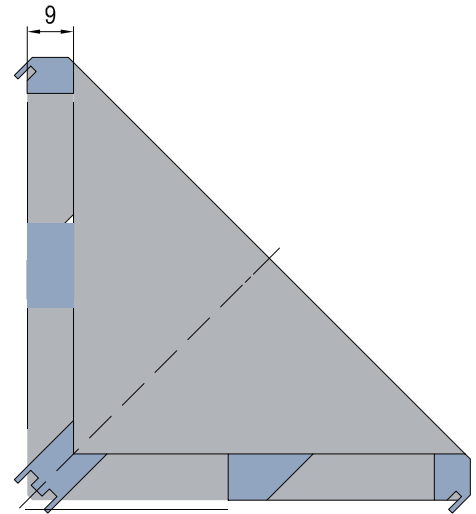
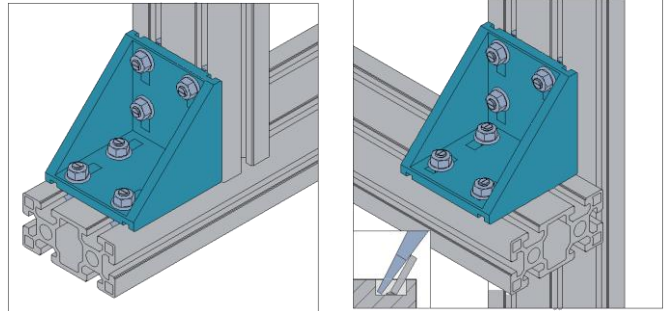

	Fastening Set		
Die Cast bracket PG30 30x30 (			3 21 45 9090
Die Cast bracket PG45 90x90 (set H)			3 21 45 9090 STH
Die Cast bracket PG45 45x45 (set J)			3 21 45 9090 STJ
Die Cast bracket PG45 90x90 (set K)			3 21 45 9090 STK



## Connecting Elements

### Inner Bracket Set (set screw pre-Installed)

Inner bracket set type A and type B are widely used to construct door / window and protective barrier frame due to its low cost high efficiency and good installation appearance.

Material : die cast zinc aluminum alloy for bracket and zinc plated steel for set screw.

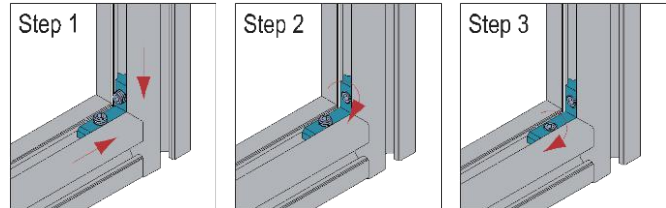
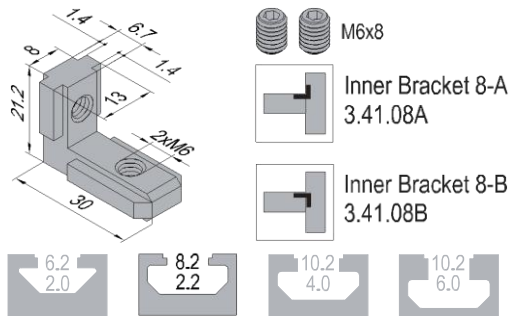
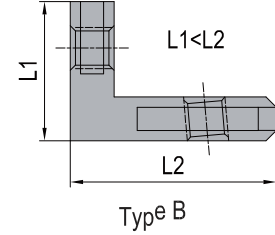
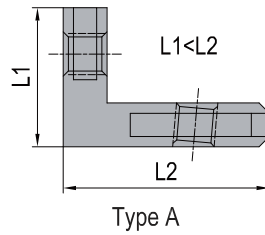
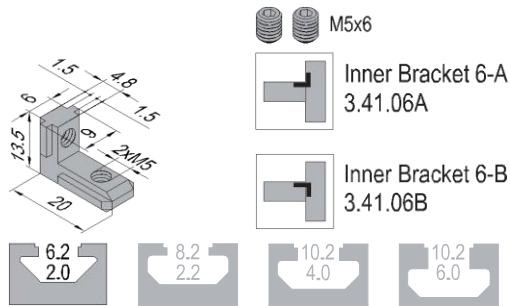
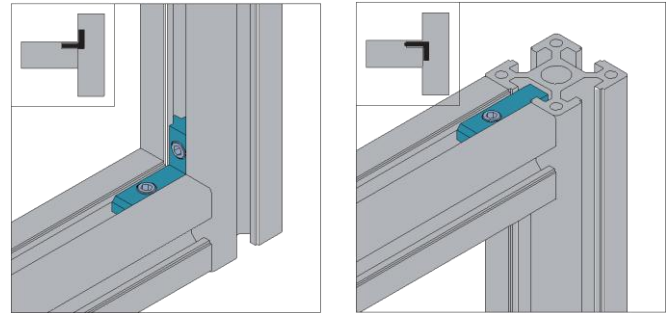

set parts in position

tighten L1 set screw

tighten L2 set screw

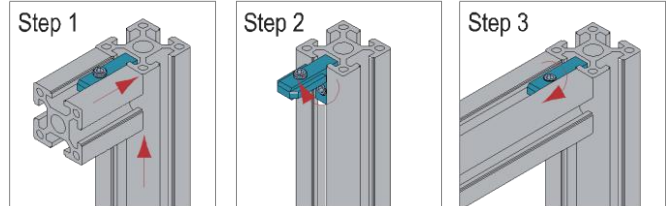
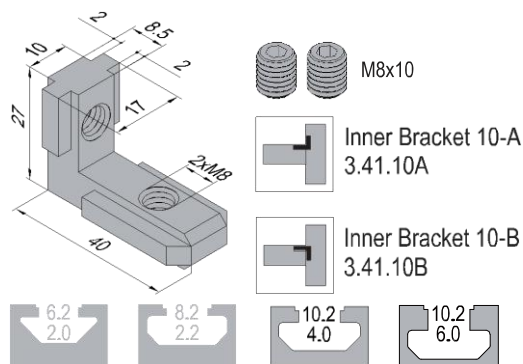

Description	Mass (g)	Part No
Inner Bracket 6 A (with set screw)		
Inner Bracket 6 B (with set screw)	6	3.41.06B
Inner Bracket 8 A (with set screw)		
Inner Bracket 8 B (with set screw)	18	3.41.08B
Inner Bracket 10 A (with set screw)		
Inner Bracket 10 B (with set screw)	36	3.41.10B

Connecting Elements

Linear Bar Connector (with set screw)

Material : zinc plated steel for bar and set screw.

Linear Bar Connector-6

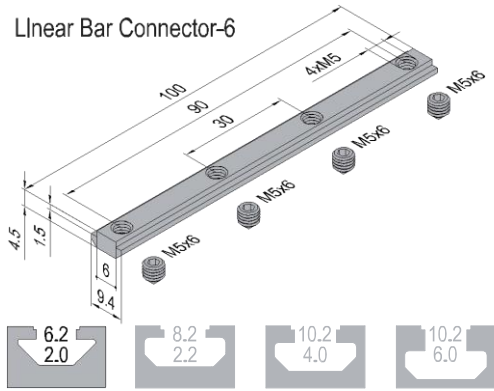

Linear Bar Connector 6 (with set screw)		
Linear Bar Connector 6 (with set screw)		
Linear Bar Connector 10 (with set screw)		

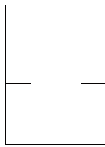

## Connecting Elements

### Butt Connector

Butt Connectors are widely used for clean room system and profile bar subsequent installation.

Material : nickel plated die cast zinc aluminium alloy

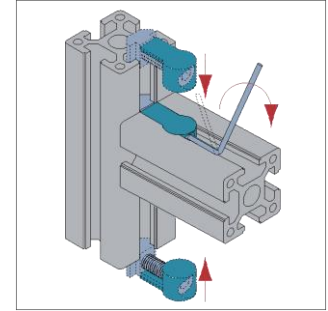

### Butt Connector-8

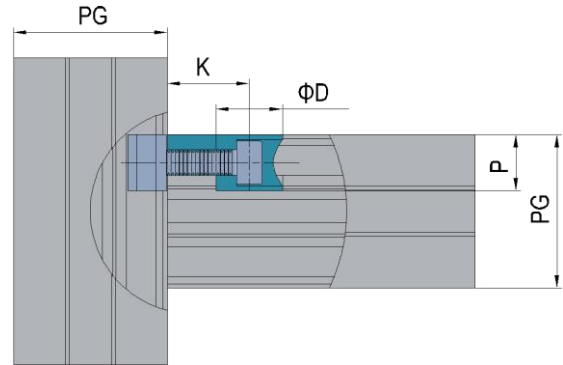
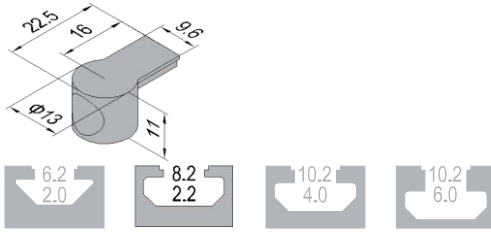

### Butt Connector-10

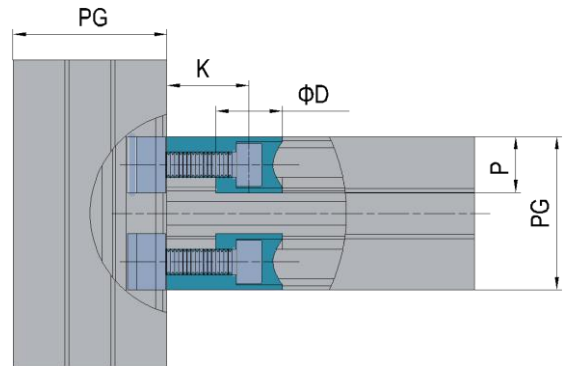
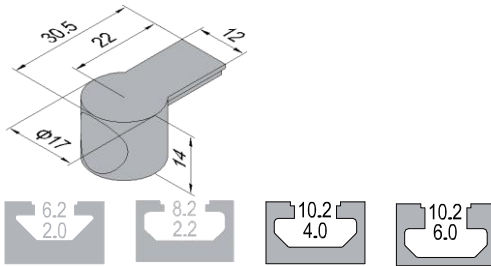

Q	Fastening Set	T	Fastening Set
	M5x20 Bolt zinc plated		M8x25 Bolt zinc plated
	M5 Pre-set nut nickel plated		M8 Pre-set nut nickel plated

	Profile Group	K (mm)	D (mm)	Fastening Set	
Butt Connector 8 (					
Butt Connector 8 (set)	PG30	16	13		08 ST
Butt Connector 10 (					
Butt Connector 10 4 (set)	PG40	22	17		3 61
Butt Connector 10 4 (set)	PG45/PG50/PG60				3 61 10 06 ST

## Connecting Elements

### End Connector

End connector is also called butterfly button connector due to its shape which can hide itself completely in aluminum profile bars, so it is widely used to set up clean frames.

Material: nickel plated steel

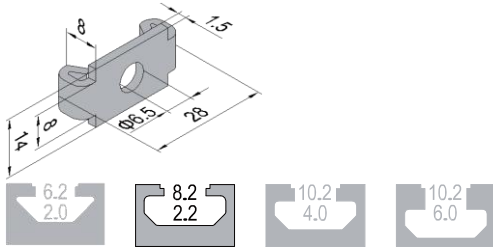

### End Connector-8



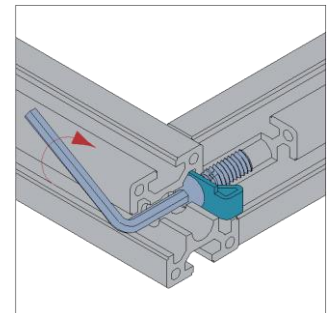
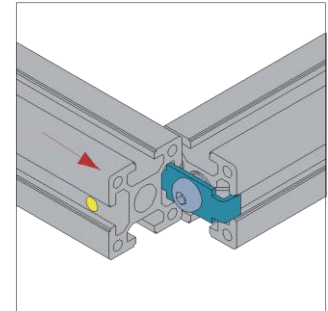
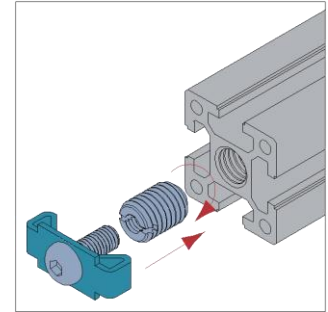
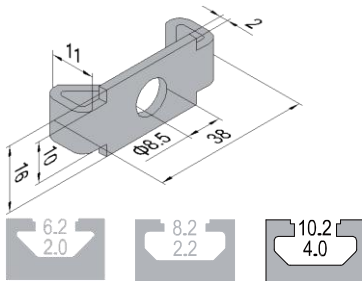

### End Connector-10



tlon	Fastening Set		
End Connector 8 (			
End Connector 8 (set)			
End Connector 10 (			
End Connector 10 (set)			

FA	Fastening Set
	M6x20 Bolt zinc plated
	M12 → M6 Hole Reducer zinc plated

FB	Fastening Set
	M8x20 Bolt zinc plated
	M14 → M8 Hole Reducer zinc plated



Profile Accessories

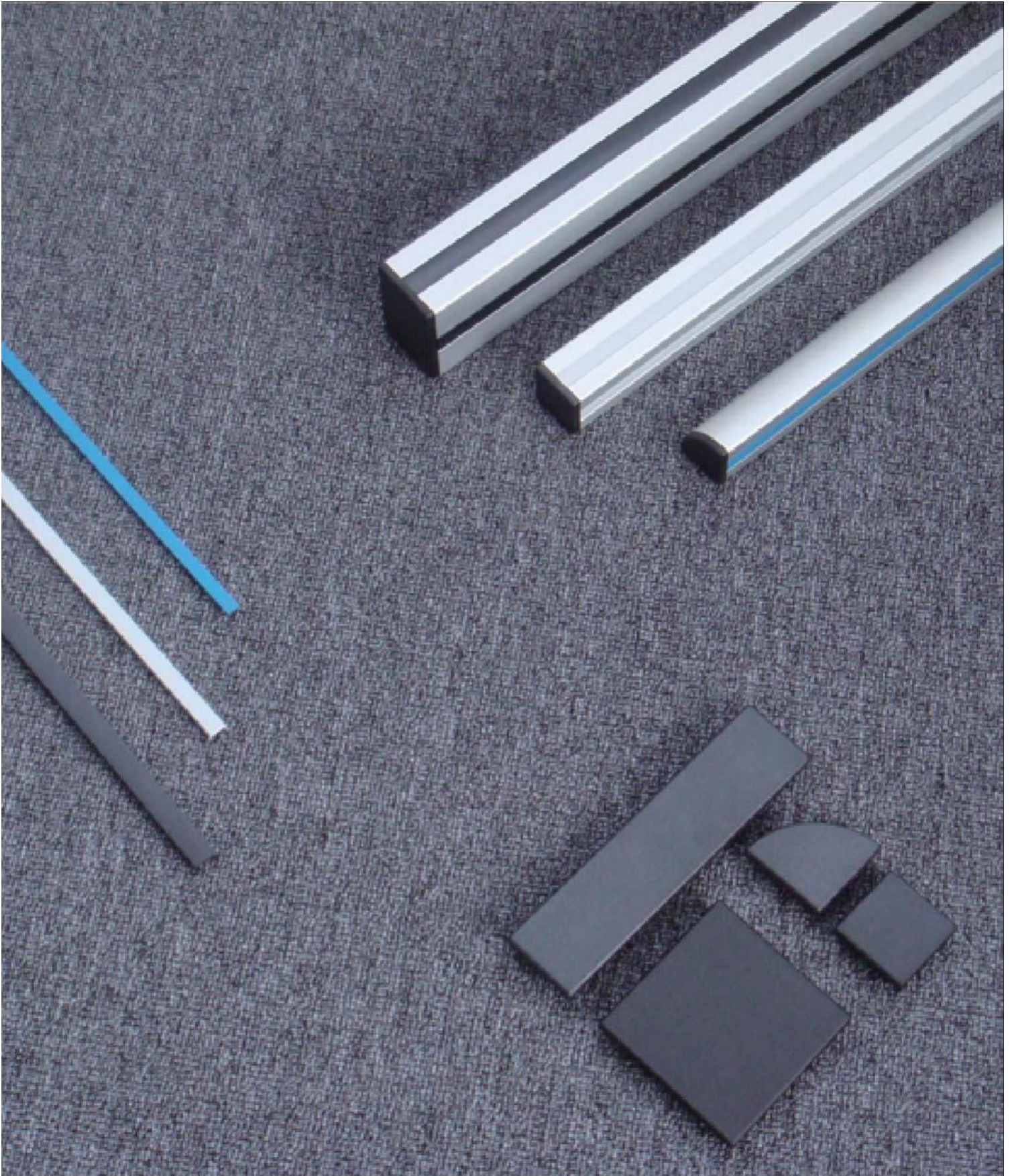





Profile Accessories

T Slot Cover

To prevent slot from contamination and Improve structure appearance .

Material and Color : PVC Black/Blue/Grey/Safety Orange

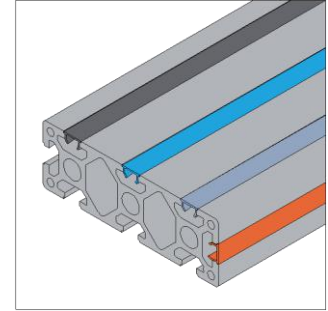

T Slot Cover-6

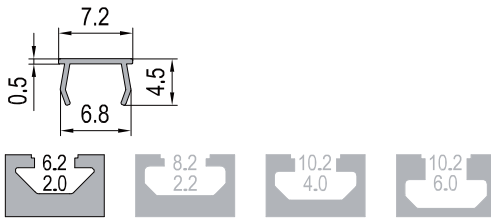

Description	Color	Mass(y/m) Mass(y/m)	Delivery Length	Part No
			2000mm/bar	
T Slot Cover 6	Blue	11	2000mm/bar	4 21 06 BE
			2000mm/bar	
T Slot Cover 6	Safety Orange Safety Orange	11	2000mm/bar	4 21 06 SE

T Slot Cover-8

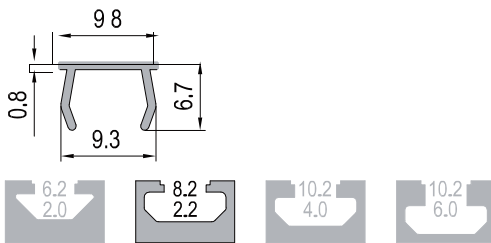

Description	Color	Mass(y/m)	Delivery Length	Part No
T Slot Cover 8	Black	22	2000mm/bar	4 21 08 BK
T Slot Cover 8	Blue	22	2000mm/bar	4 21 08 BE
T Slot Cover 8	Grey	22	2000mm/bar	4 21 08 GY
T Slot Cover 8	Safety Orange	22	2000mm/bar	4 21 08 SE

T Slot Cover-10

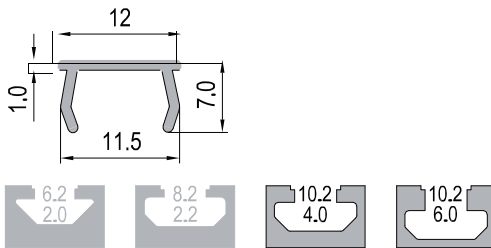

Description	Color	Mass(y/m)	Delivery Length	Part No
T Slot Cover 10	Black	38	2000mm/bar	4 21 10 BK
T Slot Cover 10	Blue	38	2000mm/bar	4 21 10 BE
T Slot Cover 10	Grey	38	2000mm/bar	4 21 10 GY
T Slot Cover 10	Safety Orange	38	2000mm/bar	4 21 10 SE

Note:

1. Cut to length delivery not available, but 4000mm or Max. 5800mm delivery length available upon request.
2. Customised color upon request subjected to Min. order quantity 5000 meters.

Floor Elements





Floor Elements

Leveling Foot-Pivot Foot

To support structure where gradual height adjustment is needed, the pivot foot has a small swivelling angle to fit slightly uneven floor. The connection between the pivot base and the spindle can be released with a tool.

Material and Color: Base - black PA6  
 Spindle - zinc plated steel  
 Pad - black rubber

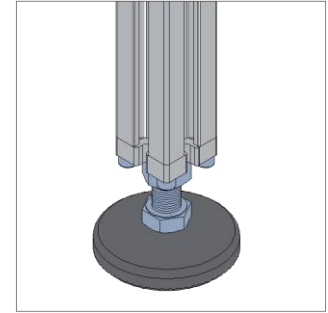

Pivot Foot (PA6 Base)

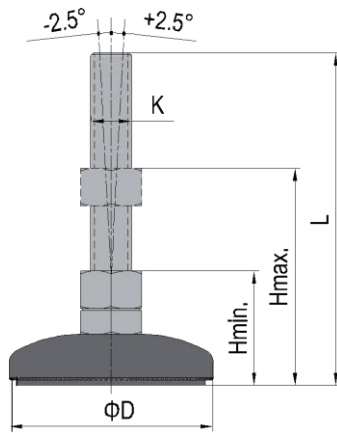

Description	D (mm)	K x L (mm)			Max Static Load (kg)		
Pivot Foot PA6 base							
Pivot Foot PA6 base							5 21 80 12 90
Pivot Foot PA6 base							5 21 80 12 130
Pivot Foot PA6 base							5 21 80 16 130
Pivot Foot PA6 base							
Pivot Foot PA6 base							5 21 100 16 130

Floor Elements

Leveling Foot-Swivel Foot

To support structure where gradual height adjustment is needed, the swivel foot has a ball joint between the base and spindle, thus allowing the foot to swivel to an angle of up to 30°. When using the foot on installations that need to be moved regularly.

Material and Color: Base - black PA6  
 Spindle - zinc plated steel  
 Pad - black rubber

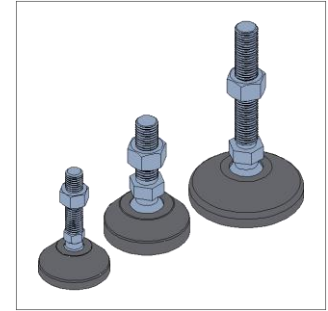

Swivel Foot (PA6 Base)

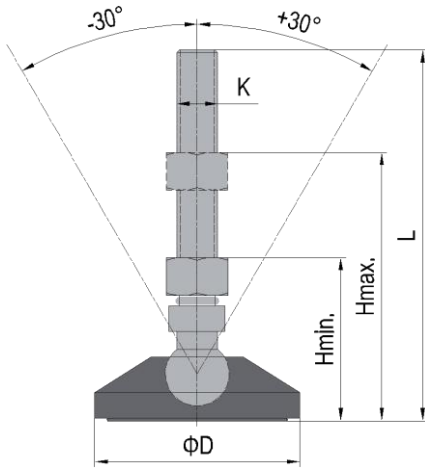

Description	D (mm)	K x L (mm)	H min (mm)	H max (mm)	Max Static Load (kg)
Swivel Foot PA6 Base					5 22 60 12 90
Swivel Foot PA6 Base					5 22 80 12 90
Swivel Foot PA6 Base					5 22 80 12 130
Swivel Foot PA6 Base					5 22 80 16 130
Swivel Foot PA6 Base					5 22 100 12 130
Swivel Foot PA6 Base					5 22 100 16 130



Floor Elements

Leveling Foot-Pivot Foot

To support structure where gradual height adjustment is needed, the pivot foot has a small swivelling angle to fit slight uneven floor. The connection between the pivot base and the spindle can be released with a tool.

Material : zinc plated steel / stainless steel

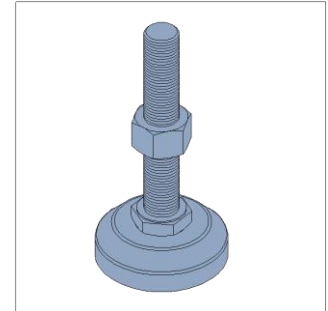

Pivot Foot-Zinc Plated Steel / Stainless Steel

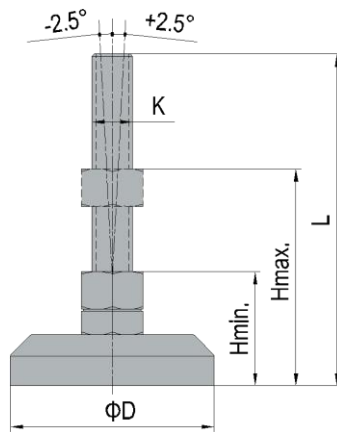

Description	D (mm)	K x L (mm)	H min (mm)	H			
Pivot Foot Zinc Plated Steel							
Pivot Foot Zinc Plated Steel							5 24 60 16 160
Pivot Foot Zinc Plated Steel							5 24 60 20 180
Pivot Foot Stainless Steel							5 24 60 12 130 SS
Pivot Foot Stainless Steel							5 24 60 16 160 SS
Pivot Foot Stainless Steel							5 24 60 20 180 SS



Floor Elements

Mounting Plate

To attach levelling foot to strut profile end.

Material : die cast aluminum alloy

Mounting Plate PG40 40x80

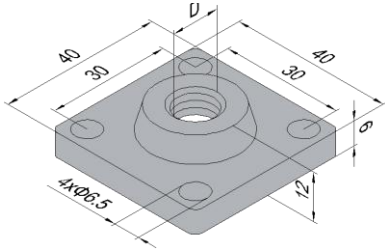

Mounting Plate PG40 40x80

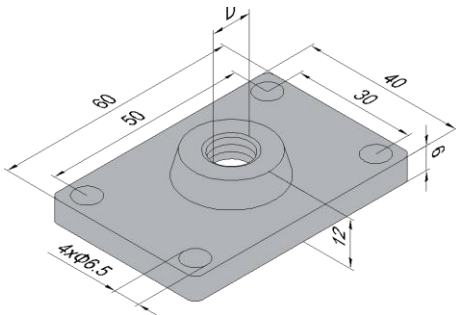

Mounting Plate PG40 40x80

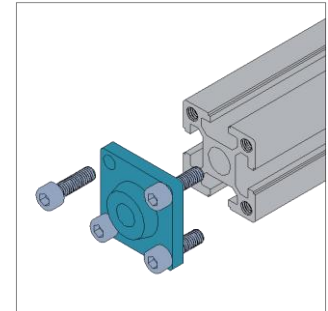
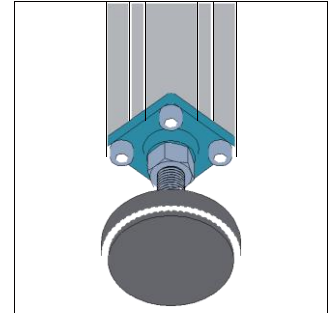
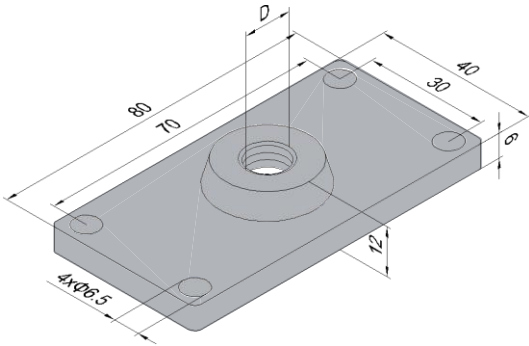

Item	Fastening Set	
Mounting Plate PG40 40x40		
Mounting Plate PG40 40x60		
Mounting Plate PG40 40x80		5 31 40 4080 M12
Mounting Plate PG40 40x80	4x(M6x20)	5 31 40 4080 M16

Note:offer per set (Including fastening set)

Floor Elements

Mounting Plate

To attach levelling foot to strut profile end.

Material : die cast aluminum alloy

Mounting Plate PG40 40x80

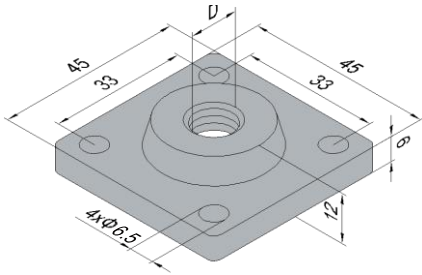

Mounting Plate PG40 40x80

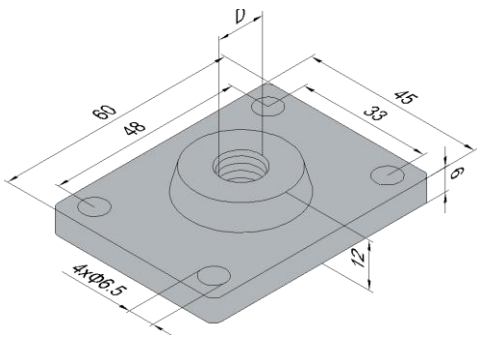

Mounting Plate PG40 40x80

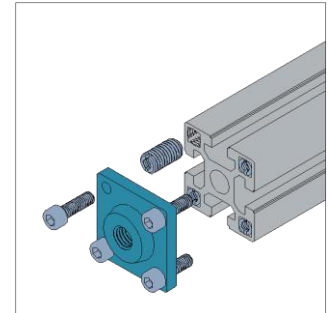
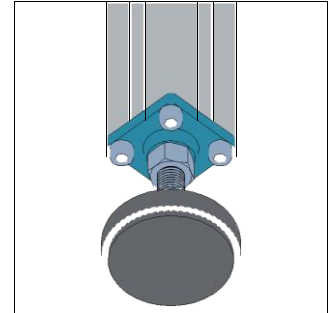
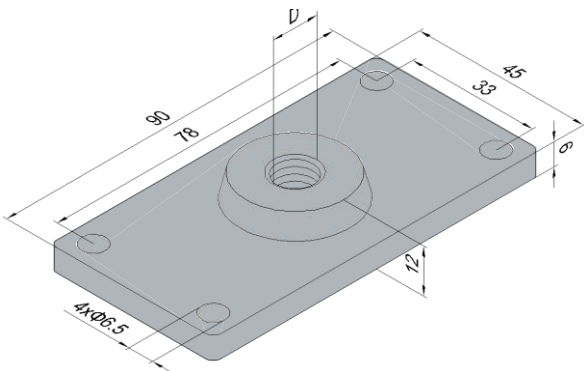

FC	Fastening Set
	M6x20 Bolt zinc plated
	M10-M6 Hole Reducer zinc plated

Note:offer per set (Including fastening set)

Item	Fastening Set	(y)	Part No
Mounting Plate PG40 40x80			
Mounting Plate PG40 40x80			5 31 45 4560
Mounting Plate PG40 40x80			5 31 45 4590 M12
Mounting Plate PG40 40x80			5 31 45 4590 M16

Floor Elements

Mounting Plate

To attach levelling foot or castor to strut profile end.

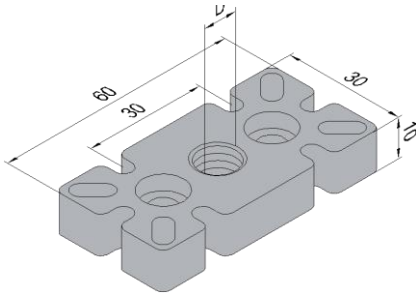

Material : zinc plated steel

Mounting Plate PG40 40x80

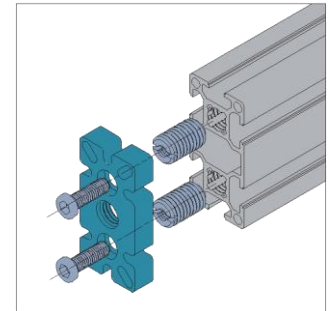
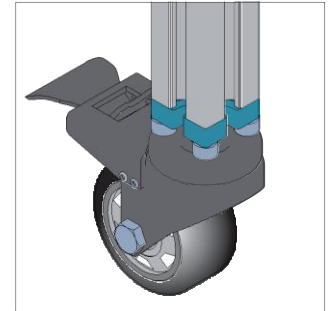
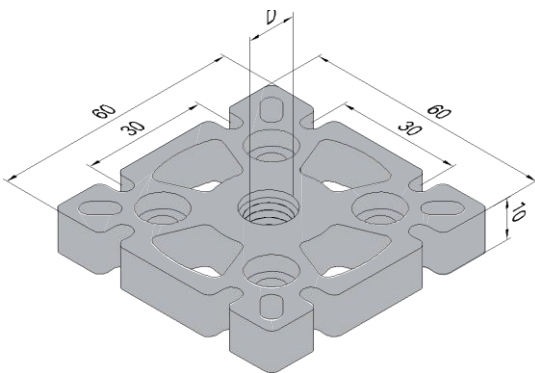

Mounting Plate PG40 40x80



FZ	Fastening Set
	M6x20 Bolt zinc plated
	M12-M6 Hole Reducer zinc plated

tlon	Fastening Set	Part No
Mounting Plate PG30 30x60		5 32 30 3060
Mounting Plate PG30 60x60		5 32 30 6060 M12
Mounting Plate PG30 30x60		5 32 30 6060 M16

Note:offer per set (Including fastening set)

Floor Elements

Mounting Plate

To attach leveling foot or castor to strut profile end.

Material : zinc plated steel

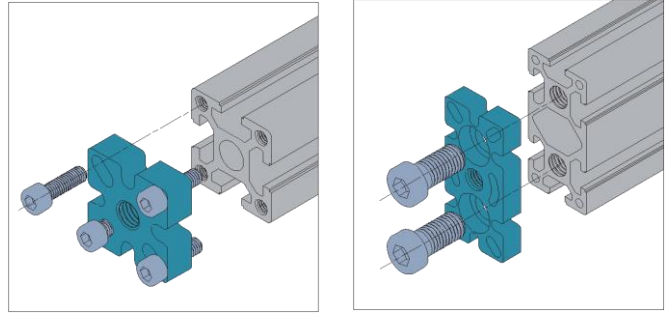

Mounting Plate PG30 30x60

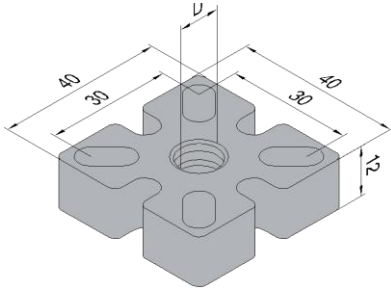

Mounting Plate PG30 30x60

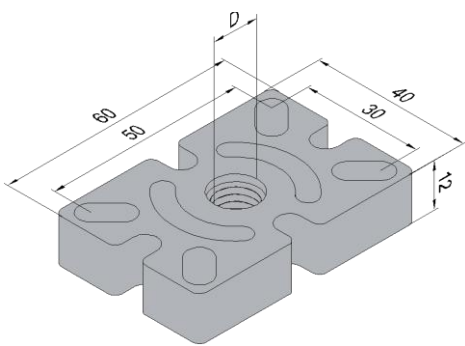

Mounting Plate PG30 30x60

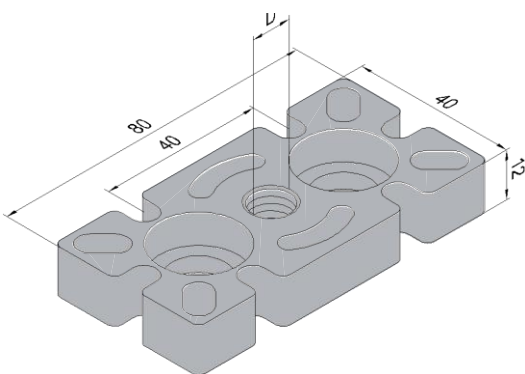

Description	D	Fastening Set	Mass (g)	Part No.
Mounting Plate-PG40-40x40	M12	4x(M6x20)	128	5.32.40.4040
Mounting Plate-PG40-40x60	M12	4x(M6x20)	176	5.32.40.4060
Mounting Plate-PG40-40x80	M12	2x(M14x25)	272	5.32.40.4080.M12
Mounting Plate-PG40-40x80	M16	2x(M14x25)	270	5.32.40.4080.M16
Mounting Plate-PG40-80x80	M12	4x(M14x25)	534	5.32.40.8080.M12
Mounting Plate-PG40-80x80	M16	4x(M14x25)	532	5.32.40.8080.M16
Mounting Plate-PG40-80x80	M20	4x(M14x25)	530	5.32.40.8080.M20

Note:offer per set (Including fastening set)

Mounting Plate-PG40-80x80

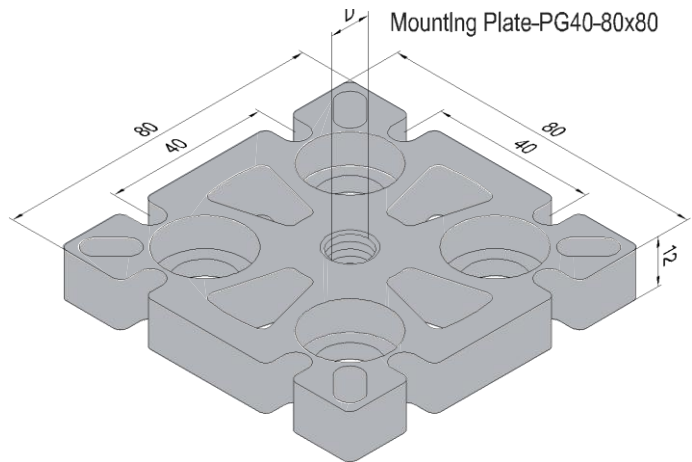

Floor Elements

Mounting Plate

To attach levelling foot or castor to strut profile end.

Material : zinc plated steel

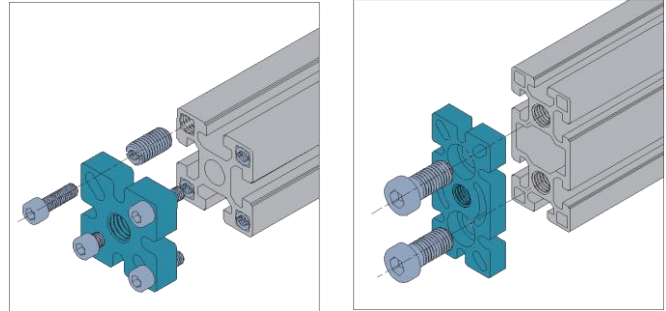

Mounting Plate-PG45-45x45

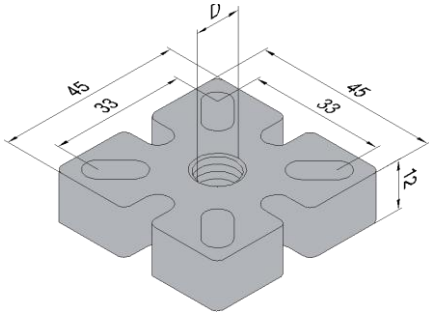

Mounting Plate-PG45-45x60

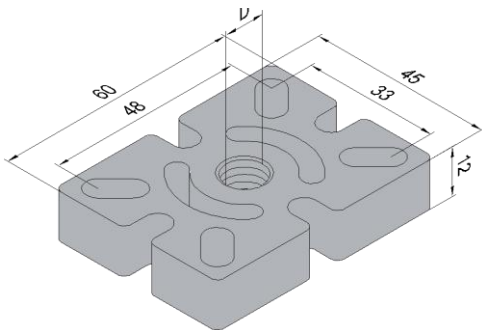

Mounting Plate PG30 30x60

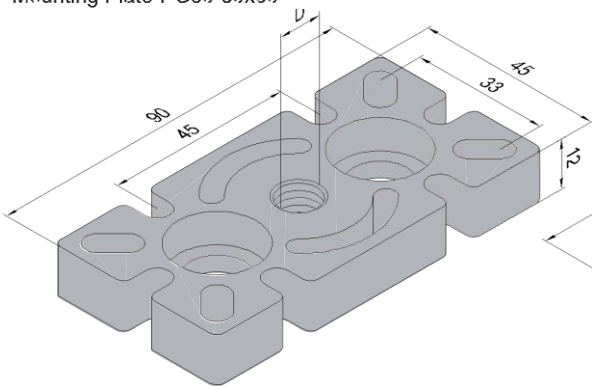

Mounting Plate PG40 40x80

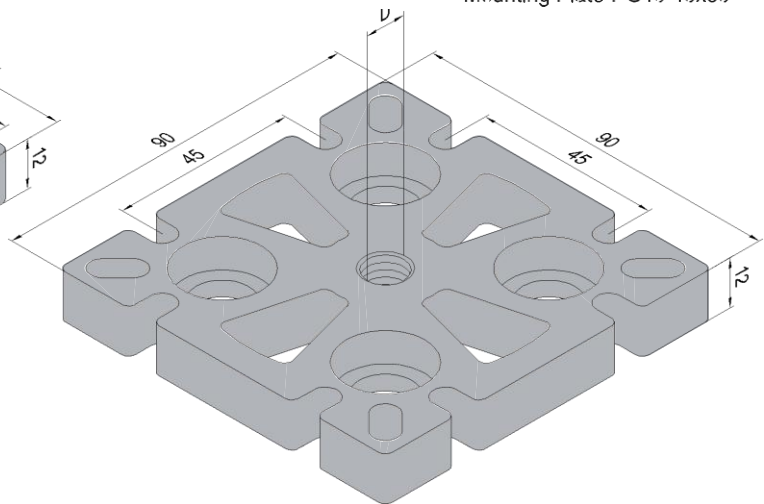

Description	D	Fastening Set	Mass (g)	Part No.
Mounting Plate-PG45-45x45	M12	4xFC	203	5.32.45.4545
Mounting Plate-PG45-45x60	M12	4xFC	220	5.32.45.4560
Mounting Plate-PG45-45x90	M12	2x(M14x25)	332	5.32.45.4590.M12
Mounting Plate-PG45-45x90	M16	2x(M14x25)	330	5.32.45.4590.M16
Mounting Plate-PG45-90x90	M12	4x(M14x25)	664	5.32.45.9090.M12
Mounting Plate-PG45-90x90	M16	4x(M14x25)	661	5.32.45.9090.M16
Mounting Plate-PG45-90x90	M20	4x(M14x25)	659	5.32.45.9090.M20

Note:offer per set (Including fastening set)

**FC** Fastening Set

- M6x20 Bolt zinc plated
- M10 → M6 Hole Reducer zinc plated

Floor Elements

Mounting Plate

To attach levelling foot or castor to strut profile end.

Material : zinc plated steel

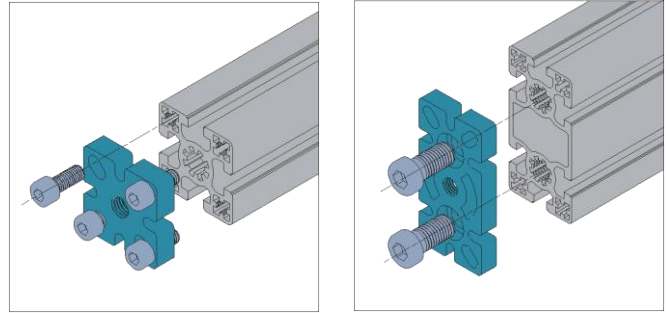

Mounting Plate-PG50-50x50

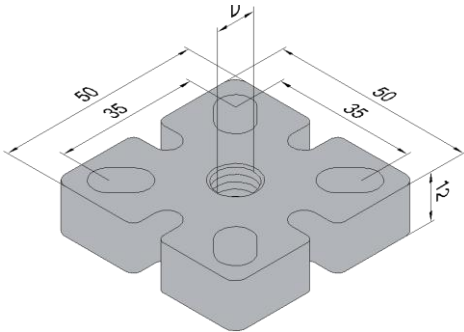

Description	D	Fastening Set	Mass (g)	Part No.
Mounting Plate-PG50-50x50	M12	4x(M8x20)	218	5.32.50.5050
Mounting Plate-PG50-50x100	M12	2x(M14x25)	332	5.32.50.50100.M12
Mounting Plate-PG50-50x100	M16	2x(M14x25)	329	5.32.50.50100.M16
Mounting Plate-PG50-50x100	M20	2x(M14x25)	327	5.32.50.50100.M20
Mounting Plate-PG50-100x100	M12	4x(M14x25)	725	5.32.50.100100.M12
Mounting Plate-PG50-100x100	M16	4x(M14x25)	722	5.32.50.100100.M16
Mounting Plate-PG50-100x100	M20	4x(M14x25)	720	5.32.50.100100.M20

Mounting Plate-PG50-50x100

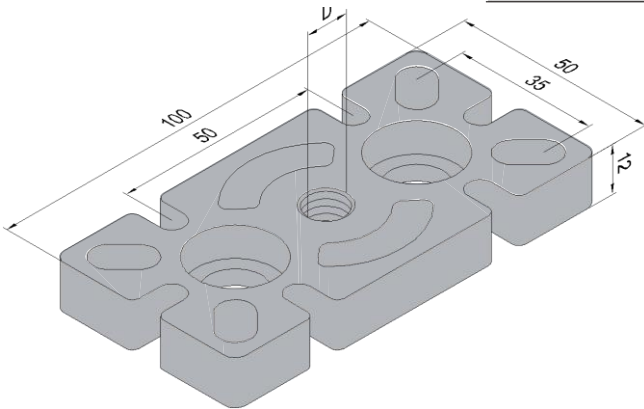

Note:offer per set (including fastening set)

Mounting Plate-PG50-100x100

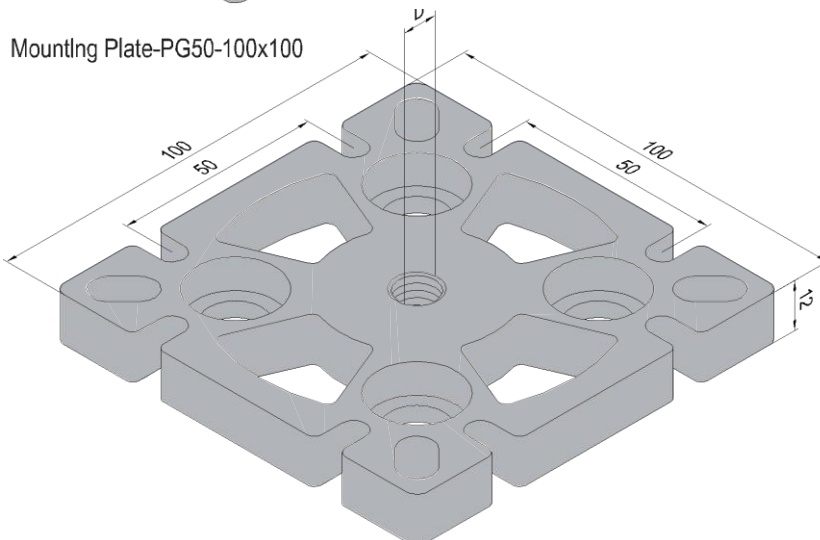

Floor Elements

Mounting Plate

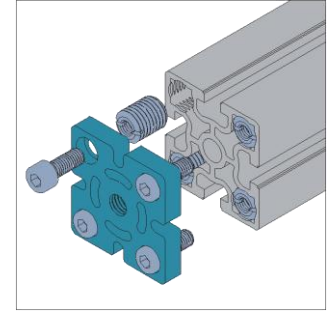

To attach levelling foot or castor to strut profile end.

Material : zinc plated steel

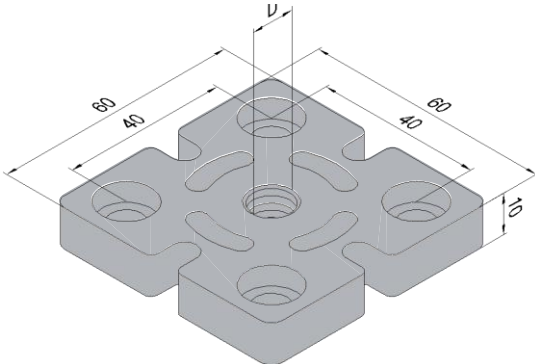

Mounting Plate-PG60-60x60



FY	Fastening Set
	MBx20 Bolt zinc plated
	M16→M8 Hole Reducer zinc plated

Item	Fastening Set	Part No
Mounting Plate PG60 60x60		5 32 60 6060

Note:offer per set (Including fastening set)



Floor Elements

Castor

Material and Color : Base - steel sheet, plastic powder coated, black  
 Wheel - polyurethane

Castor-Thread-Universal

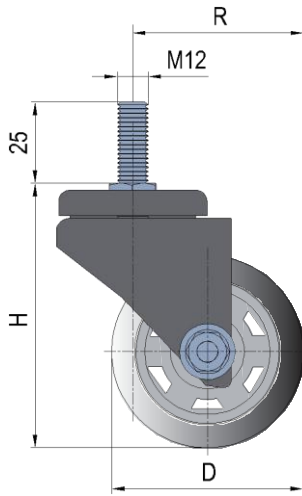

Castor-Thread-Brake

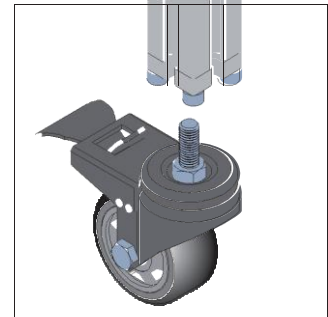
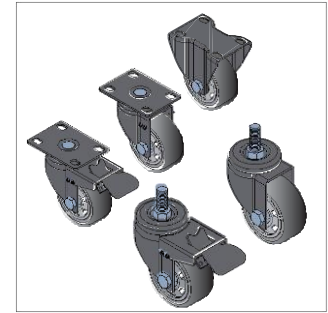
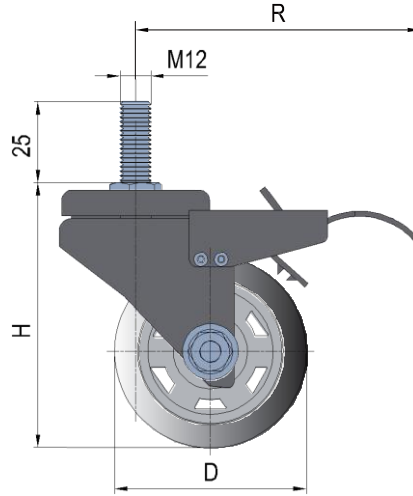

Description	D (mm)	R (mm)	H (mm)	Load (N)	Mass (g)	Part No
Castor Thread Universal						
Castor Thread Brake						

Floor Elements

Castor

Material and Color : Plate - steel sheet, plastic powder coated, black  
 Wheel - polyurethane

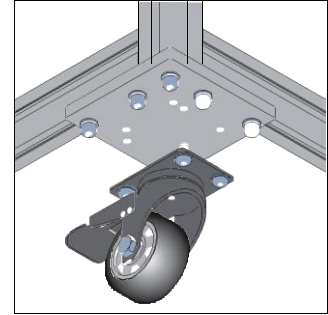

Castor-Plate-Fixed

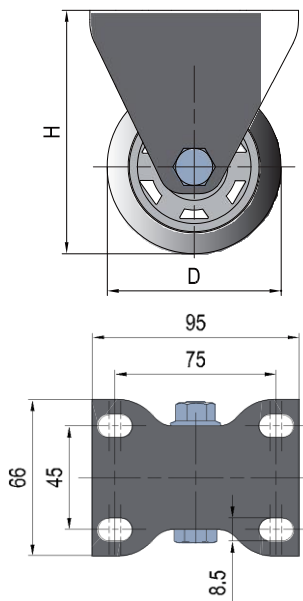

Castor-Plate-Universal

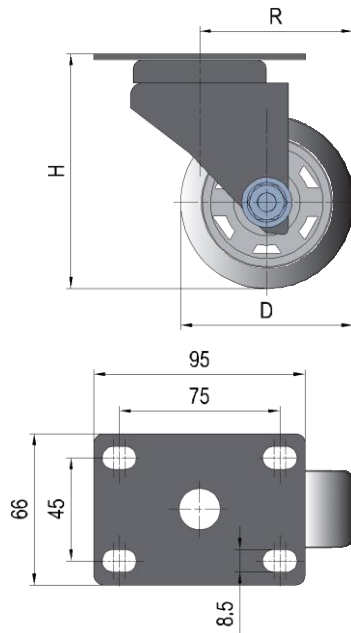

Castor-Plate-Brake

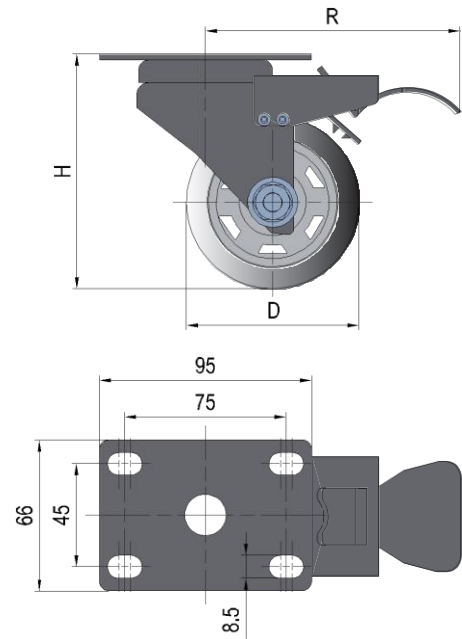

Description	D (mm)	H (mm)	R (mm)	Load (N)	Mass (g)	Part No
Castor Plate Fixed						
Castor Plate Universal						
Castor Plate Brake						

Panel Installation Elements



Panel Installation Elements

T Slot Reducing Profile

To reduce slot width for panel installation.

Material and Color : black PVC

T Slot Reducing Profile-8

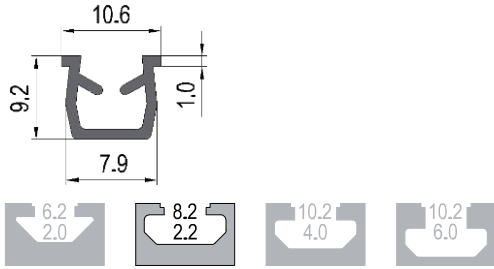

T Slot Reducing Profile-10

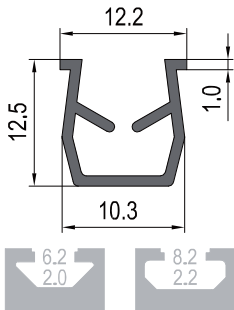

	Mass(g/m)		
T Slot Reducing Profile 8		2000mm/bar	
T Slot Reducing		2000mm/bar	

Panel Installation Elements

Panel Mounting Block

To attach panel to strut profile, choosing block attach face can get two different Indent for various panel thickness.

Material and Color : Block - black PP

Nut Insert - zinc plated steel

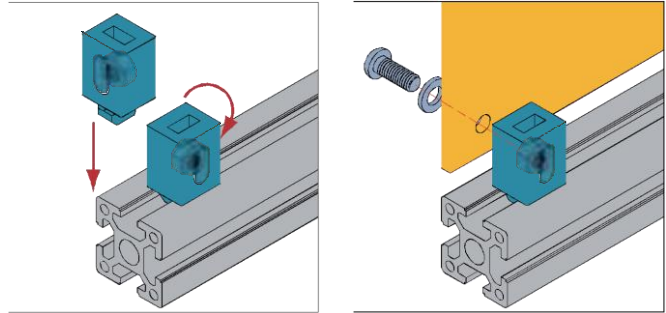

Panel Mounting Block-6

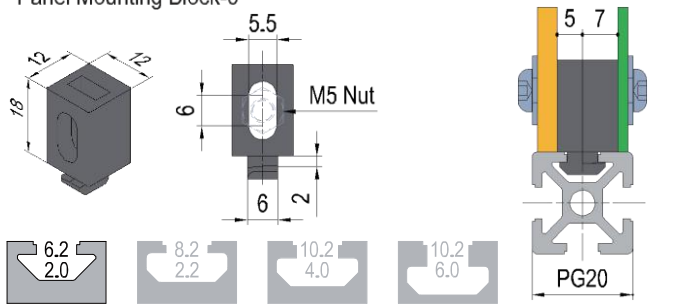

Panel Mounting Block-8

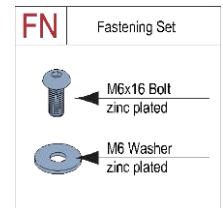
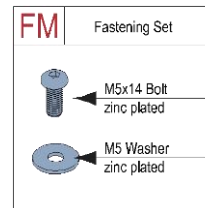
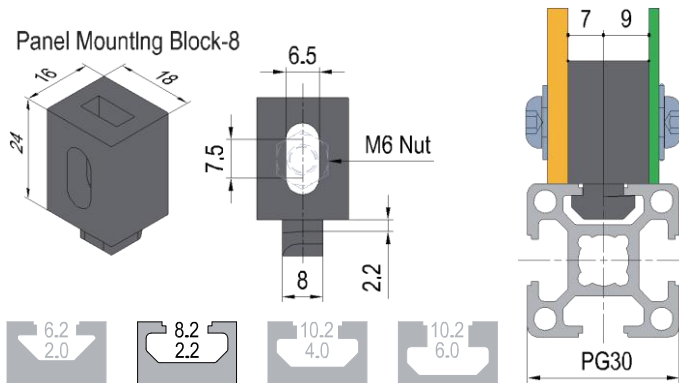

Item	Fastening Set		
Panel Mounting Block 6 (unit)			
Panel Mounting Block 6 (set)			
Panel Mounting Block 8 (unit)			
Panel Mounting Block 8 (set)			



Panel Installation Elements

Panel Mounting Block

To attach panel to strut profile, changing block attach face can get two different Indent for varles panel thickness.

Material and Color: Block - black PP

Nut Insert - zinc plated steel

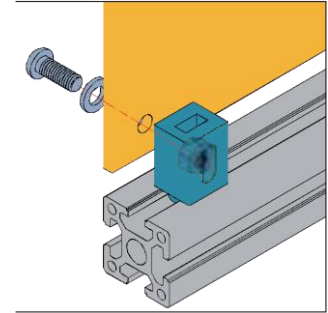
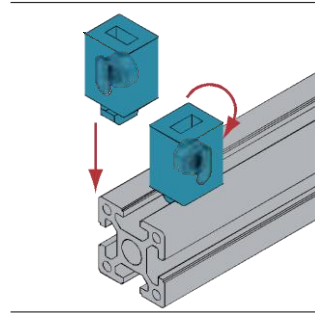

Panel Mounting Block-10-4

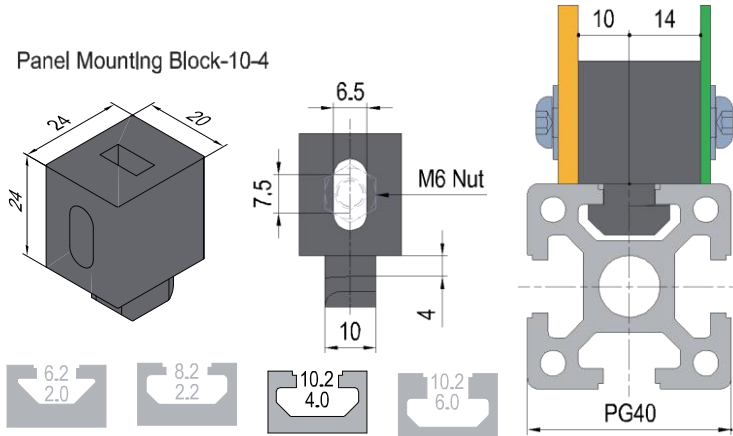

Panel Mounting Block-10-6

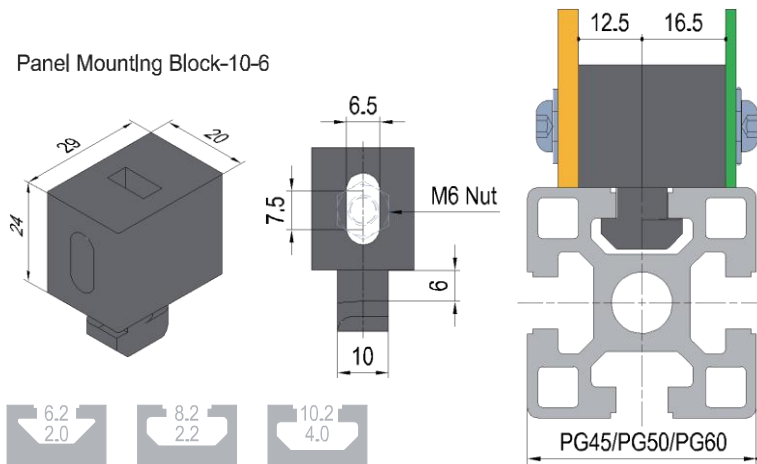

FP	Fastening Set
	M6x25 Bolt zinc plated
	M6 Washer zinc plated

Descri	Fastening Set		
Panel Mounting Block 10 4 (unit)			
Panel Mounting Block 10 4 (set)			
Panel Mounting Block 10 6 (unit)			
Panel Mounting Block 10 4 (set)			





Door and Window Elements

Handle

To open and close door or window.

Material and Color : PA6, black;  
aluminum alloy, plastic powder coated, black

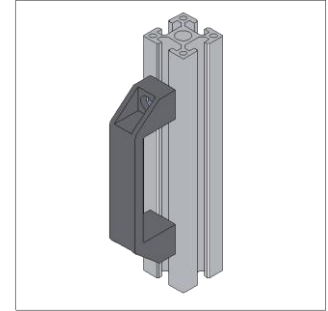

PA6 Handle

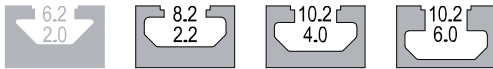
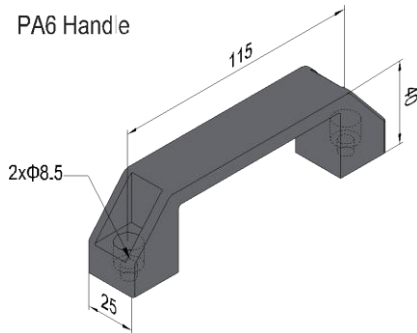

Aluminum Alloy Handle

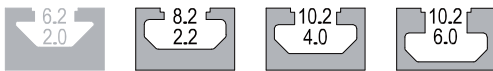
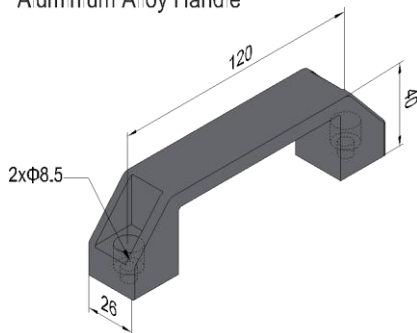

FD	Fastening Set
	M8x16 Bolt zinc plated
	M8 T-nut nickel plated

Descr	Fastening Set		
PA6 Handle (set for slot 8)			
PA6 Handle (set for slot 10)			
Aluminum Alloy Handle (			
Aluminum Alloy Handle (set for slot 8)			
Aluminum Alloy Handle (set for slot 10)			



Door and Window Elements

Hinge

To open and close door or window.

Material and Color : aluminum alloy, clear anodized

Hinge-Aluminum Alloy-Countersink Hole-30/30

Hinge-Aluminum Alloy-Countersink Hole-30/45

Hinge-Aluminum Alloy-Countersink Hole-30/45

Hinge-Aluminum Alloy-Countersink Hole-30/45

Hinge-Aluminum Alloy-Countersink Hole-30/45

Hinge-Aluminum Alloy-Countersink Hole-30/45

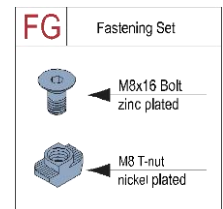
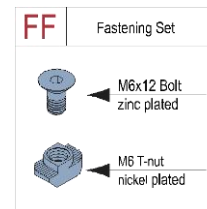
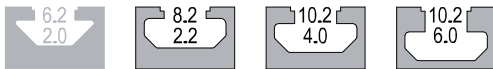
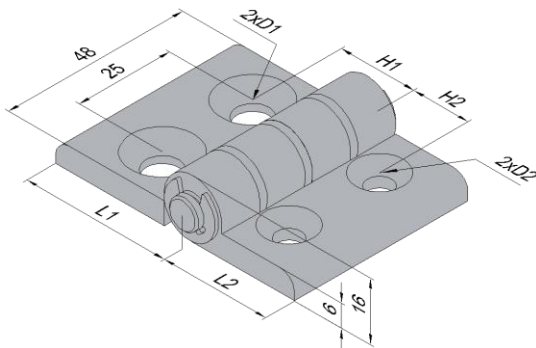
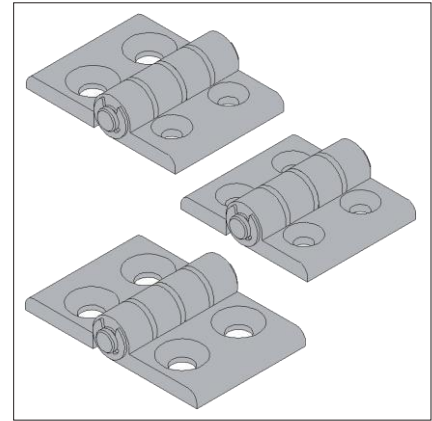

Description	H1(mm)	H2(mm)	L1(mm)	L2(mm)	D1(mm)	D2(mm)	Fastening Set	Mass (g)	Part No.
Hinge-30/30 (unit)	15	15	28	28	Φ6.5	Φ6.5		69	7.22.30.30
Hinge-30/30 (set)	15	15	28	28	Φ6.5	Φ6.5	4xFF	97	7.22.30.30.ST
Hinge-30/40 (unit)	20	15	38	28	Φ8.5	Φ6.5		74	7.22.30.40
Hinge-30/40 (set)	20	15	38	28	Φ8.5	Φ6.5	2xFF+2xFG	122	7.22.30.40.ST
Hinge-30/45 (unit)	22.5	15	38	28	Φ8.5	Φ6.5		74	7.22.30.45
Hinge-30/45 (set)	22.5	15	38	28	Φ8.5	Φ6.5	2xFF+2xFG	122	7.22.30.45.ST
Hinge-40/40 (unit)	20	20	38	38	Φ8.5	Φ8.5		81	7.22.40.40
Hinge-40/40 (set)	20	20	38	38	Φ8.5	Φ8.5	4xFG	149	7.22.40.40.ST
Hinge-40/45 (unit)	22.5	20	38	38	Φ8.5	Φ8.5		81	7.22.40.45
Hinge-40/45 (set)	22.5	20	38	38	Φ8.5	Φ8.5	4xFG	149	7.22.40.45.ST
Hinge-45/45 (unit)	22.5	22.5	38	38	Φ8.5	Φ8.5		81	7.22.45.45
Hinge-45/45 (set)	22.5	22.5	38	38	Φ8.5	Φ8.5	4xFG	149	7.22.45.45.ST

# Door and Window Elements-Hinge

## Door and Window Elements

### Hinge

To open and close door or window.

Material and Color : aluminum alloy, clear anodized

Hinge-Aluminum Alloy-Through Hole-30/30

Hinge-Aluminum Alloy-Through Hole-30/40

Hinge-Aluminum Alloy-Through Hole-30/45

Hinge-Aluminum Alloy-Through Hole-30/40

Hinge-Aluminum Alloy-Through Hole-30/40

Hinge-Aluminum Alloy-Through Hole-45/45

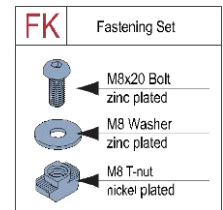
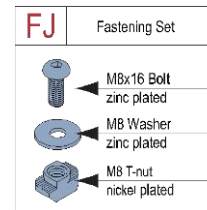
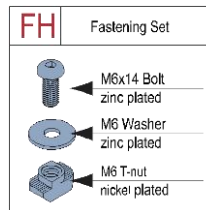
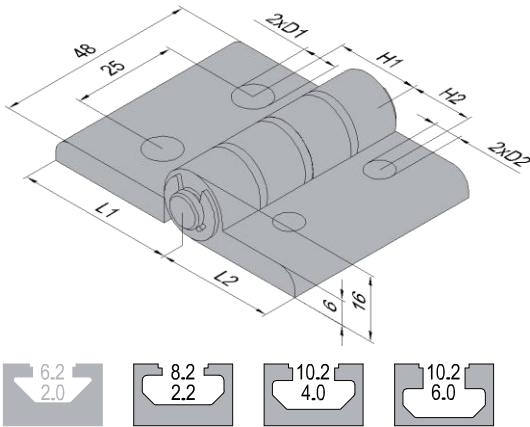
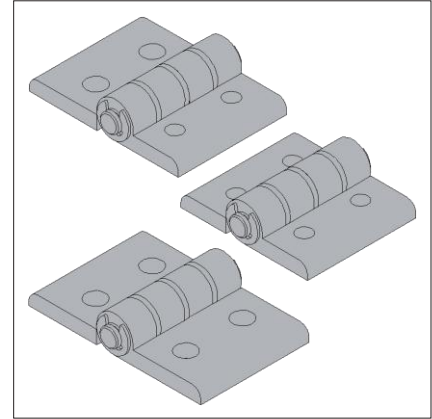

Description	H1(mm)	H2(mm)	L1(mm)	L2(mm)	D1(mm)	D2(mm)	Fastening Set	Mass (g)	Part No.
Hinge-30/30 (unit)	15	15	28	28	Φ6.5	Φ6.5		71	7.23.30.30
Hinge-30/30 (set)	15	15	28	28	Φ6.5	Φ6.5	4x <b style="color: red;">FH</b>	99	7.23.30.30.ST
Hinge-30/40 (unit)	20	15	38	28	Φ8.5	Φ6.5		76	7.23.30.40
Hinge-30/40 (set)	20	15	38	28	Φ8.5	Φ6.5	2x <b style="color: red;">FH</b> +2x <b style="color: red;">FJ</b>	124	7.23.30.40.ST
Hinge-30/45 (unit)	22.5	15	38	28	Φ8.5	Φ6.5		76	7.23.30.45
Hinge-30/45 (set)	22.5	15	38	28	Φ8.5	Φ6.5	2x <b style="color: red;">FH</b> +2x <b style="color: red;">FK</b>	127	7.23.30.45.ST
Hinge-40/40 (unit)	20	20	38	38	Φ8.5	Φ8.5		83	7.23.40.40
Hinge-40/40 (set)	20	20	38	38	Φ8.5	Φ8.5	4x <b style="color: red;">FJ</b>	151	7.23.40.40.ST
Hinge-40/45 (unit)	22.5	20	38	38	Φ8.5	Φ8.5		83	7.23.40.45
Hinge-40/45 (set)	22.5	20	38	38	Φ8.5	Φ8.5	2x <b style="color: red;">FJ</b> +2x <b style="color: red;">FK</b>	156	7.23.40.45.ST
Hinge-45/45 (unit)	22.5	22.5	38	38	Φ8.5	Φ8.5		83	7.23.45.45
Hinge-45/45 (set)	22.5	22.5	38	38	Φ8.5	Φ8.5	4x <b style="color: red;">FK</b>	161	7.23.45.45.ST

Door and Window Elements

Lock

Compact metal lock with self-locking design.

Material and Color : die cast zinc, plastic powder coated, black

Lock

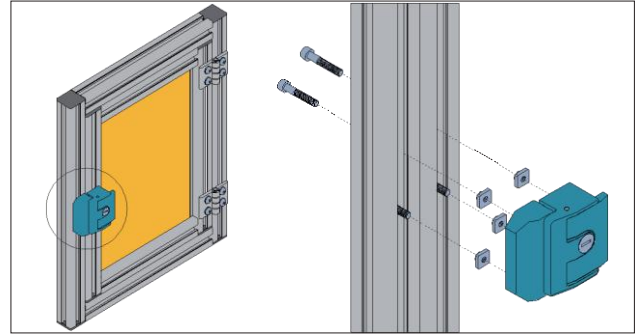
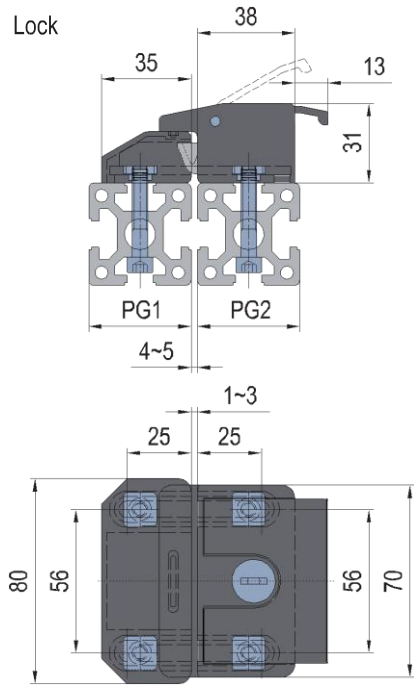

			Fastening Set		
			2x(M6x35) 2x(M6x40)		

Note:offer per set (Including fastening set)







Additional Accessories

Suspended Gilder

Element for tool suspension in profile slot.

Material and Color: gilder - PA6+GF30, black  
hook - zinc plated steel

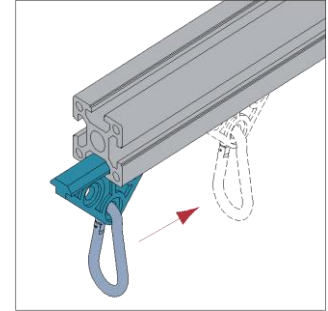

Suspended Gilder-8

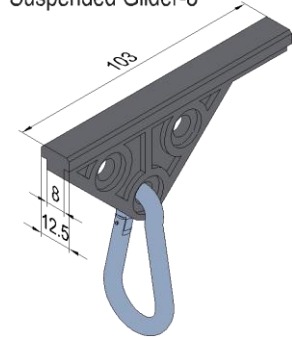

Description	Static Load (N)	Mass (g)	Part No
ended Gilder 8			

Suspended Gilder-10

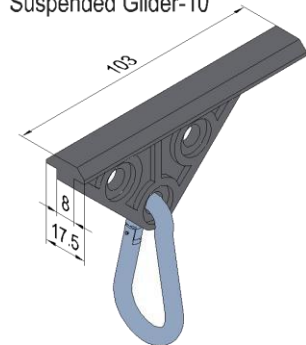

	Static Load (N)		

## Additional Accessories-Swivel Angle Plate

### Additional Accessories

#### Swivel Angle Plate

Infinitely variable adjusting of Inclination with swivel angle.

Material : steel, plastic powder coated

Color: black

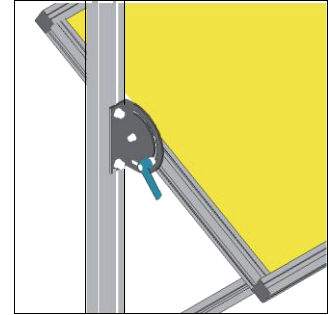
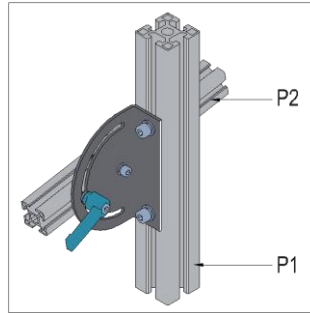

#### Swivel Angle Plate-PG30

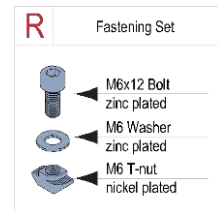
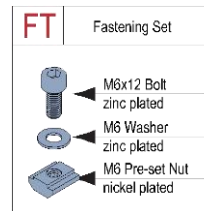
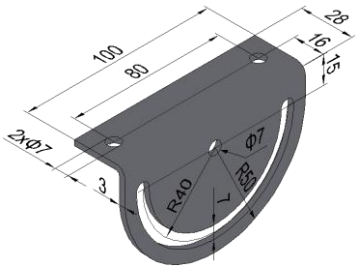

Description	P1	Fastening Set		
Swivel Angle Plate PG30 (				
Swivel Angle Plate PG30 (set)				

#### Swivel Angle Plate-PG40/45

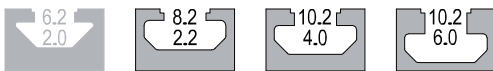
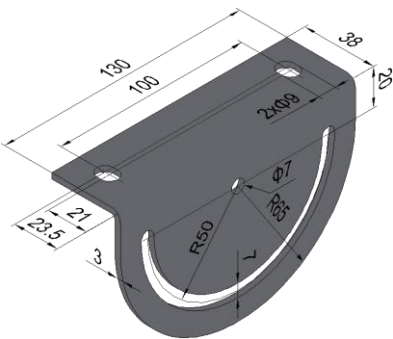

Description	P1	Fastening Set		
Swivel Angle Plate PG40/45 (				
Swivel Angle Plate PG40/45 PG30 (set)				8 21 40 30 ST
Swivel Angle Plate PG40/45 PG40/45 (set)				

## Additional Accessories-Joint



### Additional Accessories

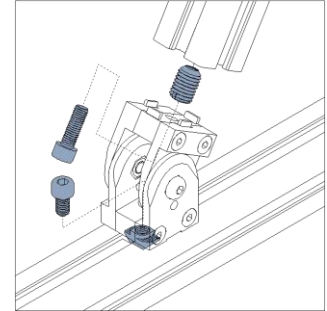
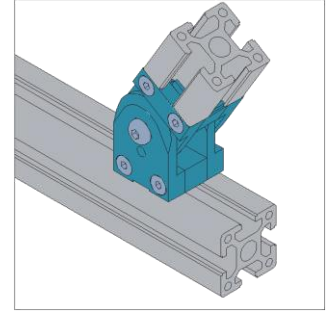
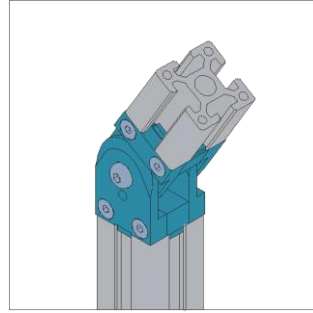
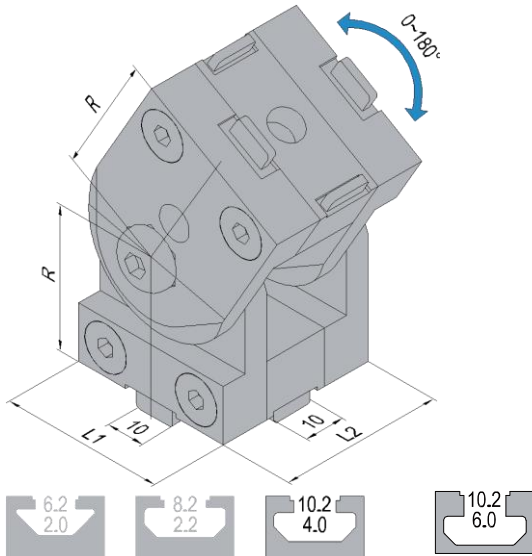

#### Joint

To attach electrical box or connect movable profiles.

Material and Color: zinc plated steel



FX	Fastening Set
	M8x20 Bolt zinc plated
	M14 → M8 Hole Reducer zinc plated

FD	Fastening Set
	M8x16 Bolt zinc plated
	M8 T-nut nickel plated

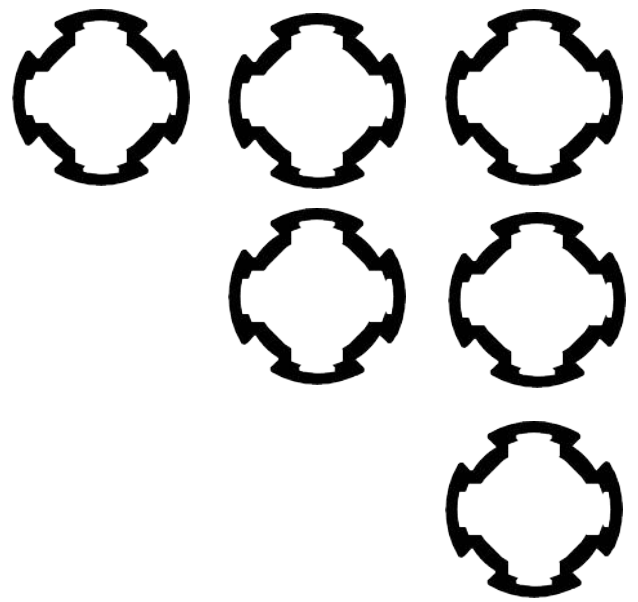

**CATRONICA.COM**



**Catronica**

**COMERCIALCATRONICA@GMAIL.COM 3196545259**

**f CCATRONICA @ CCATRONICA**